

## KL-0140-2 Meter for Coefficient of Friction



For accurate adjustment of bearing pre-load when repairing Steering Racks, Gearboxes, Differentials, etc.

### Technical Data:

Measuring range:	0 - 6 N
Drive:	1/2"

## KL-0301 Toothed Socket Rear Axle Drive Shaft Flange MB

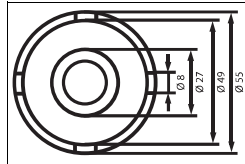

Suitable for Mercedes W116, W123, W126 Rear Axle Drive Shaft Flange.

### Technical Data:

Drive:	3/4"
Length:	80 mm
Weight:	420 g

## KL-0302 Toothed Socket Gearbox Flange MB

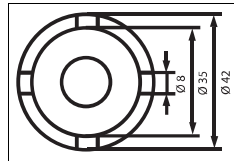

Suitable for Mercedes Gearbox Flange.

### Technical Data:

Drive:	3/4"
Length:	70 mm
Weight:	440 g

## KL-0303 Toothed Socket Differential Flange MB

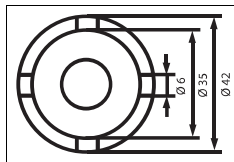

Suitable for Mercedes Differential Flange.

### Technical Data:

Drive:	3/4"
Length:	70 mm
Weight:	370 g

## KL-0304 Special bi-hex Socket 30 mm



Suitable for BMW 3 series (E36, E46); Citroen Saxo; Ford Galaxy; Mercedes E-Class (W211), C-Class (W203), SL (W129), W123, W124, W126, W201; Opel Astra F, Astra G; Renault Scenic, Clio, Kangoo; Toyota Avensis, Picnic and VW Golf (III, IV), Lupo, Touareg, T5 etc.

The special socket is particularly suitable for loosening and tightening the mounting nut, for example, on rear or front axle drive shafts, on wheel bearings, as well as on gearbox or differential flange.

### Technical Data:

Size (width across flats):	30 mm
Profile:	bi-hex
Drive:	1/2"
Length:	80 mm
Weight:	350 g

## KL-0305 Special bi-hex Socket 32 mm



Suitable for Fiat Punto; Ford Escort, Mondeo; Mercedes S-Class (W140); Nissan Almera, Opel Astra H, Vivaro; Subaru Outback etc.

The special socket is particularly suitable for loosening and tightening the mounting nut, for example, on rear or front axle drive shafts, on wheel bearings, as well as on gearbox or differential flange.

### Technical Data:

Size (width across flats):	32
Profile:	bi-hex
Drive:	1/2"
Length:	75 mm
Weight:	450 g

Pry Bar

KL-0190-94

This pry bar made of special steel is ideal for:

- Dismantling stubborn components.
- Positioning and holding components in required position.
- Spreading clamp-fixtures, etc.

Technical Data:

Length	900 mm
Blade width	24mm



Pry Bar Set

KL-0193-95

Made of special steel for:

- Dismantling stubborn components.
- Positioning components.
- Holding components in required position.
- Checking suspension ball joints and silentblocs.

Technical Data:

Length	Blade width 1 / 2	Weight
730 mm	24 / 33 mm	1600 g
1050 mm	24 / 33 mm	1900 g



Pry Bar Set

KL-0193-90

Set consists of four hard-wearing pry bars made of special steel that are ideal for:

- Removing stubborn components.
- Positioning components.
- Holding components in required position.
- Spreading clamp-fixtures, etc.

Scope of Delivery: KL-0193-90 Pry Bar Set

Part No.	Length	Blade width
KL-0193-904	24" (610 mm)	20 mm
KL-0193-903	18" (460 mm)	20 mm
KL-0193-902	12" (310 mm)	16 mm
KL-0193-901	8" (200 mm)	10 mm



Pin-type Face Spanners; adjustable, riveted or welded

KL-0149-...

KL-0149-111 - KL-0149-143

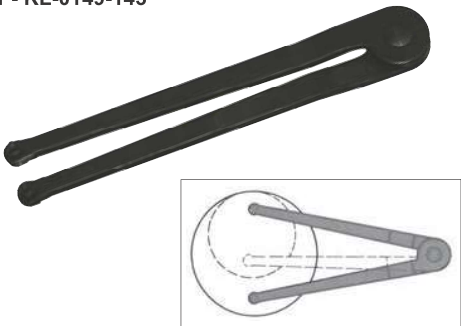

**Pin-Type Face Spanner, adjustable**  
For twin-hole nuts, with riveted or welded pins (not replaceable).  
Special steel, gunmetal finish.

Part-No.						
KL-0149-111	7-40 mm	1.5 mm	2.8 mm	115 mm	3 mm	40 g
KL-0149-112		2 mm	3.6 mm			
KL-0149-113		2.5 mm	4 mm			
KL-0149-121	11-60 mm	3 mm	4 mm	160 mm	4 mm	140 g
KL-0149-122		4 mm	5 mm			
KL-0149-123		5 mm	6 mm			
KL-0149-131	14-100 mm	5 mm	6 mm	215 mm	6 mm	300 g
KL-0149-132		6 mm	7 mm			
KL-0149-133		8 mm	8 mm			
KL-0149-141	22-125 mm	8 mm	8 mm	260 mm	6 mm	500 g
KL-0149-142		10 mm	10 mm			
KL-0149-143		12 mm	12 mm			

KL-0149-211 - KL-0149-223

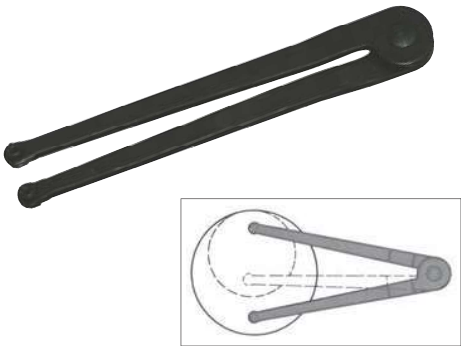
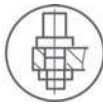

**For twin-hole nuts, with inter-changeable pins.**  
Special steel, gunmetal finish.

Part-No.						Pin (Spare Part)
KL-0149-211	11-60 mm	3 mm	4 mm	160 mm	4 mm	KL-0149-4111
KL-0149-212		4 mm	5 mm			KL-0149-4121
KL-0149-213		5 mm	6 mm			KL-0149-4221
KL-0149-222	14-100 mm	6 mm	7 mm	215 mm	6 mm	KL-0149-4231
KL-0149-223		8 mm	8 mm			KL-0149-4331

## KL-0149-... Adjustable Pin-Type Face Spanners (Special steel, gunmetal finish)

KL-0149-311 - KL-0149-342



For twin-hole nuts, with welded pins.

Part-No.						
KL-0149-311	18-40 mm	3 mm	4 mm	150 mm	5 mm	90 g
KL-0149-312		4 mm	5 mm			
KL-0149-321	40-80 mm	4 mm	5 mm			
KL-0149-322		5 mm	6 mm			
KL-0149-323		6 mm	7 mm	220 mm	6 mm	245 g
KL-0149-331	80-125 mm	6 mm	7 mm			
KL-0149-332		7 mm	7.5 mm			
KL-0149-333		8 mm	8 mm	320 mm	8 mm	670 g
KL-0149-341	125-200 mm	8 mm	8 mm			
KL-0149-342		10 mm	10 mm			
				450 mm	10 mm	1750 g

KL-0149-411 - KL-0149-442

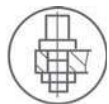

For twin-hole nuts, with inter-changeable pins.

Part-No.							Pin (Spare Part)
KL-0149-411	18-40 mm	3 mm	4 mm	150 mm	5 mm	90 g	KL-0149-4111
KL-0149-412		4 mm	5 mm				KL-0149-4121
KL-0149-421	40-80 mm	4 mm	5 mm	220 mm	6 mm	245 g	KL-0149-4211
KL-0149-422		5 mm	6 mm				KL-0149-4221
KL-0149-423		6 mm	7 mm				KL-0149-4231
KL-0149-431	80-125 mm	6 mm	7 mm	320 mm	8 mm	670 g	KL-0149-4311
KL-0149-432		7 mm	7.5 mm				KL-0149-4321
KL-0149-433		8 mm	8 mm				KL-0149-4331
KL-0149-441	125-200 mm	8 mm	8 mm	450 mm	10 mm	1750 g	KL-0149-4411
KL-0149-442		10 mm	10 mm				KL-0149-4421

## KL-0148-... Hook Spanners (Special steel, gunmetal finish)

KL-0148-311 - KL-0148-382

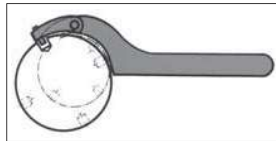

For round nuts with set pin holes inside DIN 1816.

Part-No.						
KL-0148-311	12-14 mm	2 mm	2 mm	110 mm	3 mm	25 g
KL-0148-312	16-18 mm	2.5 mm	2.5 mm			
KL-0148-321	20-22 mm	2.5 mm	2.5 mm	110 mm	3 mm	40 g
KL-0148-331	25-28 mm	3 mm	3 mm			
KL-0148-332	30-32 mm	4 mm	4 mm	136 mm	4 mm	55 g
KL-0148-341	34-36 mm	4 mm	4 mm			
KL-0148-342	40-42 mm	4 mm	3.5 mm	170 mm	5 mm	100 g
KL-0148-351	45-50 mm	5 mm	4 mm			
KL-0148-352	52-55 mm	5 mm	5 mm	240 mm	7 mm	270 g
KL-0148-361	58-62 mm	6 mm	6 mm			
KL-0148-362	68-75 mm	6 mm	6 mm	280 mm	8 mm	410 g
KL-0148-371	80-90 mm	8 mm	8 mm			
KL-0148-372	95-100 mm	8 mm	8 mm	335 mm	10 mm	780 g
KL-0148-381	110-115 mm	8 mm	8 mm			
KL-0148-382	120-130 mm	8 mm	8 mm			

KL-0148-411 - KL-0148-451

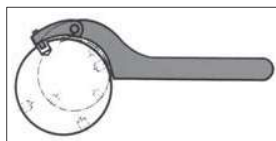

For round nuts with set pin holes inside DIN 1816

Part-No.					
KL-0148-411	20-35 mm	2.5 mm	3 mm	135 mm	40 mm
KL-0148-412		3 mm	3 mm		
KL-0148-413		4 mm	4 mm		
KL-0148-421	35-60 mm	4 mm	4 mm	175 mm	85 mm
KL-0148-422		5 mm	5 mm		
KL-0148-431	60-90 mm	5 mm	5 mm	245 mm	250 mm
KL-0148-432		6 mm	6 mm		
KL-0148-441	90-155 mm	6 mm	6 mm	300 mm	425 mm
KL-0148-442		8 mm	8 mm		
KL-0148-451	155-230 mm	8 mm	8 mm	420 mm	1015 mm

KL-0148-511 - KL-0148-515



For groove nuts DIN 1804.

Part-No.					
KL-0148-511	20-35 mm	135 mm	9 mm	4 mm	50 mm
KL-0148-512	35-60 mm	175 mm	10.5 mm	5 mm	100 mm
KL-0148-513	60-90 mm	250 mm	12.5 mm	7 mm	280 mm
KL-0148-514	90-155 mm	290 mm	14 mm	8 mm	460 mm
KL-0148-515	155-230 mm	420 mm	17.5 mm	10 mm	1200 mm





Werkzeuge fürs Leben • Tools for life

# PULLER

Twist & Pull 1.09

Especially  
quick  
and precise



1.12



1.04



1.06 HSP



1.34

Please ask for our  
catalogue:  
[www.gedore.com](http://www.gedore.com)

[www.gedore.com](http://www.gedore.com)

## KL-0152-90 K Puller Set Twin- / Triple-Arm with fast-clamp lever



KL-0152-90 K



KL-0152-91 K



For pulling off washers, gearwheels or ball bearings.

These twin- or triple-arm universal pullers with fast clamping hooks can be used as internal or external pullers, simply by repositioning the hooks.

The extremely narrow hook ends are necessary for gearbox repairs if pullers with conventional hooks cannot be inserted for space reasons.

### Advantages:

- The hooks always grip in parallel and can be attached to the bridge by means of a fast clamping lever.
- Universal application.
- Cost saving: 1 spindle and either 2 or 4 hooks are not needed..
- The best choice for the professional in rough day-to-day working conditions in industry or for work on cars or trucks..

### Technical Data:

Width:	100 mm
Height:	100 mm
Load max.:	2.5 t
Weight:	2.1 kg

### Scope of Delivery:

#### KL-0152-90 K Puller Set Twin- / Triple-Arm with fast-clamp lever

Part-No.	Description	Qty.
KL-0150-0001	Twin-Arm Yoke	1
KL-0151-0001	Triple-Arm Yoke	1
KL-0152-0002	Spindle M14x1.5 x 140 with centring tip	1
KL-0152-1103	Clamps - short	3
KL-0152-0005	Fast-clamp lever with pulling bolt	3
KL-0152-1004	Hooks without clamps (a=3.6mm)	3
KL-4990-1004	Plastic storage case (275 x 230 x 83mm)	1

#### KL-0152-91 K Puller Set Twin- / Triple-Arm w. fast-clamp lever

### Technical Data:

Width:	100 mm
Height:	100 / 200 mm
Load max.:	2.5 t. (bei a=3.6 mm) 2.0 t. (bei a = 2.0 mm)
Weight:	3.6 kg

### Scope of Delivery:

#### KL-0152-91 K Puller Set Twin- / Triple-Arm with fast-clamp lever

Part-No.	Description	Qty.
KL-0150-0001	Twin-Arm Yoke	1
KL-0151-0001	Triple-Arm Yoke	1
KL-0152-0002	Spindle M14x1.5 x 140 with centring tip	1
KL-0152-1203	Clamps - middle	3
KL-0152-1103	Clamps - long	3
KL-0152-0005	Fast-clamp lever with pulling bolt	6
KL-0152-1004	Hooks without clamps (a=3.6mm)	3
KL-0152-0004	Hooks without clamps (a=2.0mm)	3
KL-4990-1007	Plastic storage case (340 x 275 x 83mm)	1

## KL-0150-6 Special Twin-Arm Puller Set

8



The puller **KL-0150-6** is fitted with extremely pointed hook ends and an extremely narrow hook shaft (Important for transmission repair).

### Technical Data:

Width:	135 mm
Height:	100 / 200 / 250 mm
Load max.:	2 t
Weight:	3.2 kg

### Scope of Delivery:

#### KL-0150-6 Special Twin-Arm Puller Set

Part-No.	Description	Qty.
KL-0150-1501	Yoke	1
KL-0150-0002	Spindle	1
KL-0150-0003	Pair of Clamps short* (for 1 Hook)	2
KL-0150-1203	Pair of Clamps middle* (for 1 Hook)	2
KL-0150-1253	Pair of Clamps long* (for 1 Hook)	2
KL-0150-0004	Hooks without clamps (pointed/slim)	6

\* with screws for 1 hook.

Twin-Arm Puller Universal

KL-0150-...

The pullers are fitted with extremely pointed hook ends and an extremely narrow hook shaft (Important for transmission repair).  
The universal twin-arm pullers can be adapted to be inner or outer pullers by reversal of the two arms on the yoke.

Twin-Arm Puller Universal

KL-0150-0

Technical Data:	
Max. pulling width:	100 mm
Max. pulling height :	100 mm
Max. load capacity:	2 t
Weight:	1 kg

Twin-Arm Puller Universal

KL-0150-1

Technical Data:	
Max. pulling width:	100 mm
Max. pulling height :	100 mm
Max. load capacity:	3 t
Weight:	1 kg

Twin-Arm Puller Universal

KL-0150-1,5

Technical Data:	
Max. pulling width:	135 mm
Max. pulling height :	100 mm
Max. load capacity:	3 t
Weight:	1 kg

Twin-Arm Puller Universal

KL-0150-2

Technical Data:	
Max. pulling width:	170 mm
Max. pulling height :	150 mm
Max. load capacity:	5 t
Weight:	3 kg

Twin-Arm Puller Universal

KL-0150-2,5

Technical Data:	
Max. pulling width:	220 mm
Max. pulling height :	150 mm
Max. load capacity:	5 t
Weight:	3.2 kg

Twin-Arm Puller Universal

KL-0150-3

Technical Data:	
Max. pulling width:	260 mm
Max. pulling height :	200 mm
Max. load capacity:	7.5 t
Weight:	7 kg



Special Triple-Arm Puller Set

KL-0151-9

The puller **KL-0151-9** is fitted with extremely pointed hook ends and an extremely narrow hook shaft (Important for transmission repair).

Technical Data:	
Width:	135 mm
Height:	100 / 200 / 250 mm
Load max.:	2 t
Weight:	4.8 kg

Scope of Delivery:

KL-0151-9 Special Triple-Arm Puller Set

Part-No.	Description	Qty.
KL-0151-1501	Yoke	1
KL-0150-0002	Spindle	1
KL-0150-0003	Pair of Clamps short* (for 1 Hook)	3
KL-0150-1203	Pair of Clamps middle* (for 1 Hook)	3
KL-0150-1253	Pair of Clamps long* (for 1 Hook)	3
KL-0150-0004	Hooks without clamp (pointed/slim)	9

\* with screws for 1 hook.





## KL-0288-11 Oil Filler Adaptor for VW DSG Gearbox



**Suitable for VW-Audi DSG gear boxes.**

This tool is indispensable for the quick, easy and clean filling and re-filling of DSG gearboxes. The oil filler adaptor is screwed directly to the 1-Litre oil container.

The built-in shut-off valve ensures accurate filling and professional working.

### Technical Data:

Hose length:	2 m
Gearbox connecting thread:	M24x1.5

## KL-0231-31 Oil Dipstick for Gearbox VW



**Universal application.**

**Ideal suitable for VW-Audi gearboxes e.g.:**

- 012/01 Gearbox - WAudi 80 (RS2 Quattro), Cabrio, Audi A4 (1.6, 1.8 5V, 1.8 5V Turbo, 2.3 VR5, 1.9 TDI), VW Passat 3B (all petrol engines and 74kW diesel engines)
- 01E Gearbox - Audi 80 (RS2 [6-speed gearbox]), 100 (C4), A4 (from '95), S4, RS4, RS4 Quattro, VW Passat (3B [4 and 6 cylinder TDI from 96 kW 6-speed gearbox all-wheel-drive])
- 012 Gearbox - Audi 80, 100 (5-speed gearbox), A6
- 02G Gearbox - VW T4 Synchro
- Multitronic Gearbox - Audi A4 (2.0 TDI; 2.7 TDI), A6 (2.7 TDI)

This tool is required for the easy, quick, and trouble-free gear oil check.

Even on gearboxes where the gear box oil control bolts are hard to access, checking the oil level is not an issue using this tool.

### Technical Data:

Length:	360 mm
Scales length:	15 mm
Scales graduation:	1 mm
Weight:	90 g

## KL-0230-10 Bearing Puller

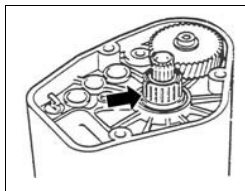

**Bearing Puller for VW Transmission 085 (e.g. VW-Golf and VW-Polo).**

Indispensable for the quick and easy removal of the needle roller bearing inner ring from the gear shaft when the synchroniser body with gearwheel has been pulled off the 5th gear.

The special design of the puller **KL-0230-10** ensures that the collet chuck of the puller completely covers the bearing inner ring, thus enabling quick and smooth removal.

### Technical Data:

Weight:	1.6 kg
Clamping Range:	40 - 43 mm

## KL-0231-1 Jointed Hex Nut Size (width across flats) 17 mm



With 3/8" drive for the gearbox oil control bolt on VW-Audi.

Ideal for use on VW Golf II and III and Audi vehicles with automatic drive, where the oil control bolt is hard to access.

### Technical Data:

Drive:	3/8"
--------	------

8

## KL-0231-2 Special Socket Insert XZN M16



**Suitable for Audi A3, A4, A6; VW Fox, Golf (IV), LT.**

This multi-teeth socket features an inner bore and is therefore the ideal tool for oil drain plugs and oil control bolts on gearboxes.

### Technical Data:

Drive:	1/2"
--------	------

## KL-0231-30 Oil Filter Key



**Suitable for the 4-wheel drive vehicles VW Bora, Golf (IV and V), Sharan, Touran 4motion as well as Audi A3 and TT Quattro etc.**

Designed to remove and install the Haldex-clutch oil filter.

### Technical Data:

Length:	400 mm
Weight:	700 g



Hydraulic Press (400 mm long)

KL-1000-0120 A

The hydraulic press **KL-1000-0120 A** is used in conjunction with the press-/ support sleeve sets of the **KL-0039-... Series** and press piece sets **KL-0159-11** and **KL-0159-12** thus enabling the pressing in and pressing out of shafts, steering knuckle bolts, bearings, sleeves, silentblochs ets. Thanks to its handy design, the hydraulic press can also be used in-situ on the vehicle.

Technical Data:

Inner width:	160 mm
Inner length:	400 mm
Maximum load capacity:	28 t
Cylinder retaining thread:	2¼"-16 UN
Weight:	14.3 kg

Scope of Delivery:

KL-1000-0120 A Hydraulic Press (400 mm long)

Part No.	Description	Qty.
KL-1000-010 A	Press frame 400 mm long with hydr. cyl. and stand	1
KL-0215-35 M28	Hydr. hand pump with hose, coupling, adaptor and pressure gauge	1

Scope of Delivery:

KL-1000-010 A Press Frame 400 mm long with hydr. cyl. and stand

Part No.	Description	Qty.
KL-1000-01	Press frame (400 mm long)	1
KL-0040-2810	Pressure spindle M24	1
KL-0039-1004	Retainer adaptor for pressure spindle Ø18 with O-Ring	1
KL-0040-2800	Hydraulic cylinder 28t	1
KL-1000-03	Mounting bracket for press frame	1



Pressure Piece Sets with storage case

KL-0159-11

For extracting and inserting bearings, shafts, bushes etc. in conjunction with a hydraulic press or any hydraulic press tool set of the **KL-0039- series**. Each set consists of one mandrel, one plug and 15 pressure pieces and is supplied in a plastic storage case.

Technical Data:

Mounting bore Ø:	10 mm
Ø A:	22 mm - 50 mm in 2 mm gradation
Ø B:	20 mm - 48 mm in 2 mm gradation

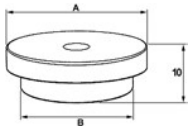

## KL-0159-12 Pressure Piece Sets with storage case



For extracting and inserting bearings, shafts, bushes etc. in conjunction with a hydraulic press or any hydraulic press tool set of the **KL-0039- series**. Each set consists of one mandrel, one plug and 15 pressure pieces and is supplied in a plastic storage case.

### Technical Data:

Mounting bore Ø:	20 mm
Ø A:	52 - 80 mm in 2 mm gradation
Ø B:	50 - 78 mm in 2 mm gradation

## KL-0095-1 Stripper Plate Size 2

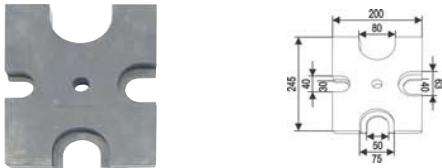

For pressing on and pressing off bearings at, e.g., rear axle shafts, transmissions and engines.

## KL-0096-1 Stripper Plate Ø 62 mm



For demounting the rear axle bearing on **Opel/Vauxhall** vehicles.

## KL-0096-2 Stripper Plate Ø 67 mm



For demounting the rear axle bearing on **Opel/Vauxhall, Ford and Fiat vehicles**.

## KL-0096-3 Stripper Plate Ø 72 mm



For demounting the rear axle bearing on **Opel/Vauxhall and Ford vehicles**.

## KL-0097-1 Stripper Plate thin-walled (4 mm)



Made of highly hardened and tempered special steel Ø1 = 30 mm; Ø2 = 45 mm. Ideal tool for very narrow clearances (up to 4 mm).

### Note:

The Stripper Plate **KL-0097-1** may also be used in conjunction with the Puller **KL-0150-2.5**.