

**The KLANN Silentboc Tool KL-0039- Series !!!!!**

**The big advantages of the unrivalled KL-0039- Tool Series are:**

- ☑ Universal use of the tool.
- ☑ Substantial time and cost savings – as the required tool can easily and universally be assembled

**2**

**Silentboc / Suspension Ball Joint – Removal and Installation using a press frame**

**Identifying the required parts and assembling the tool:**

**Mounting the tool and pressing out the silentboc / suspension ball joint**

⇒ Identifying the required parts and assembling the tool:

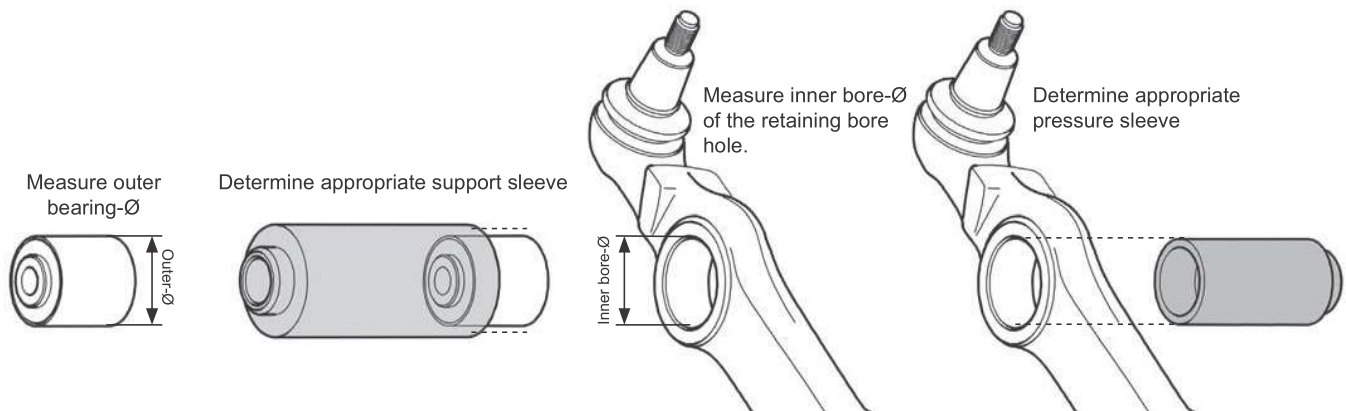

**Mount the tool as shown below and press out the silentboc / suspension ball joint**

⇒ Installation follows the same principle.

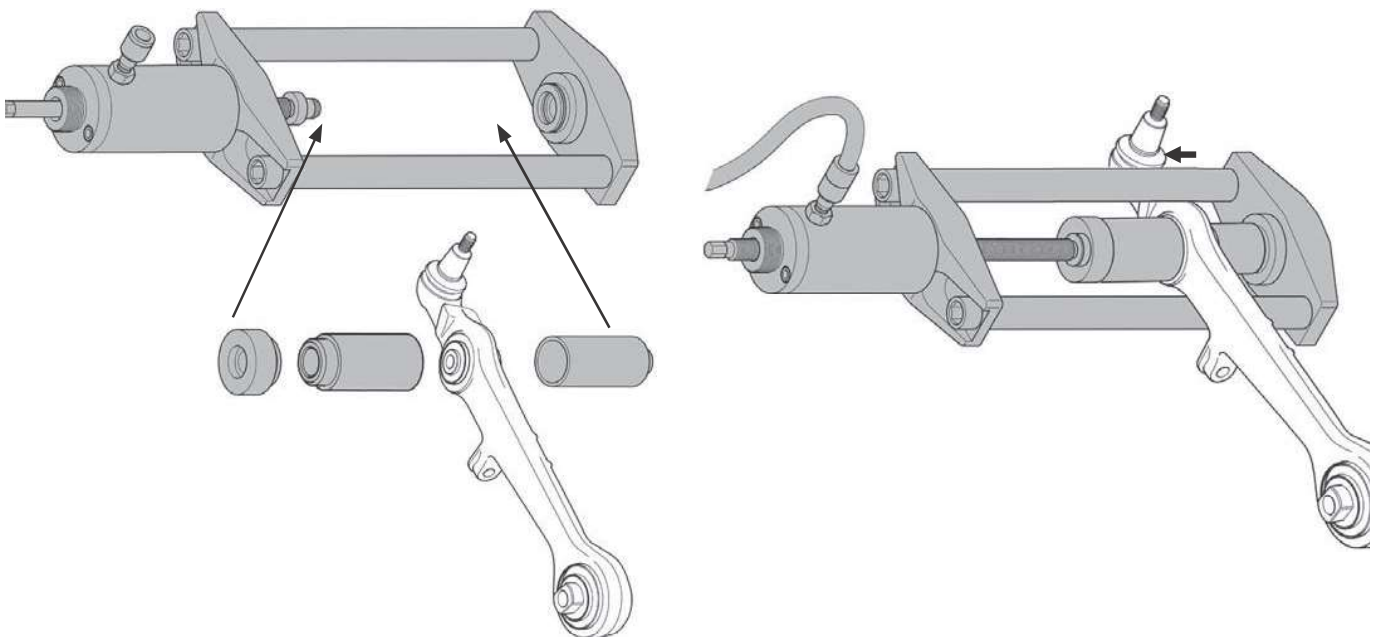

## Press Tool Set (short) with hydraulic cylinder 17 t

KL-0039-930 H

Universally suitable for silentblochs, suspension ball joints, guide joints etc.

The Press Tool Set **KL-0039-930 H** allows quick, professional and safe removal and replacement of silentblochs, ball joints, etc. with  $\varnothing$  30 - 59 mm, directly on the vehicle without having to dismantle the axle or the wishbone. The hydraulic cylinder 17 t, included in the set, ensures professional and trouble-free pressing-out of silentblochs or ball joints.

The possibility to complement the tool set with other parts of the **KL-0039-... Series**, such as e.g. pull spindles and adaptors, makes this press tool set almost universally applicable.

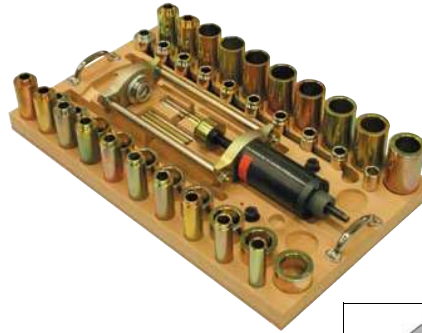

2

### Technical Data:

Inner Length (Press frame):	275 mm
Inner Width (Press frame):	115 mm
Press frame max. load:	12 t
Hydraulic cylinder max. load:	17 t

### Specification:

#### KL-0039-930 H Press Tool Set (short) with hydraulic cylinder 17 t.

Part No.	Description	Qty.
KL-0039-1140	Press frame, short	1
KL-0040-2500	Hydraulic Cylinder 17t	1
KL-0039-1930	Pressure Spindle M20x350 with O-ring	1
KL-0039-1002	Retainer Adaptor for hex nut and pressure spindle with O-ring	1
KL-0039-1601	Press/Support Sleeve Set short	1
KL-0039-1701	Press/Support Sleeve Set long	1
KL-0039-9000	Wooden Plate Empty	1

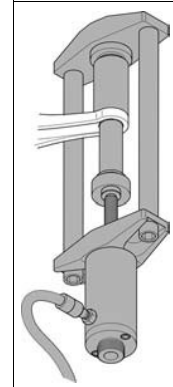

## Press Tool Set (short) without drive

KL-0039-931 H

Universally suitable for silentblochs, suspension ball joints guide joints etc.

The press tool set **KL-0039-931 H** allows the quick, professional and safe removal and replacement of silentblochs, suspension ball joints, etc. with  $\varnothing$  30 - 59 mm in-situ on the vehicle without having to remove the axle or the wishbone from the vehicle.

Using this tool set in combination with a hydraulic drive ensures professional and trouble-free extraction of silentblochs or pivoting bearings.

The possibility to easily complement the tool set with other parts of the **KL-0039-... Series** such as a mechanical drive by pull spindle, makes this press tool set almost universal in its field of application.

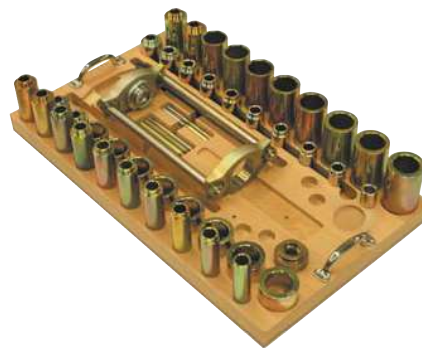

### Technical Data:

Inner length (press frame)	275 mm
Inner width (press frame)	115 mm
Max. charge of press frame:	12 t

### Scope of Delivery:

#### KL-0039-931 H Press Tool Set (short) without drive

Part No.	Description	Qty.
KL-0039-1140	Press frame, short	1
KL-0039-1002	Retainer Adaptor for hex nut and pressure spindle with O-ring	1
KL-0039-1930	Pressure Spindle M20x350 with O-ring	1
KL-0039-1601	Press/Support Sleeve Set short	1
KL-0039-1701	Press/Support Sleeve Set long	1
KL-0039-9000	Wooden Plate Empty	1

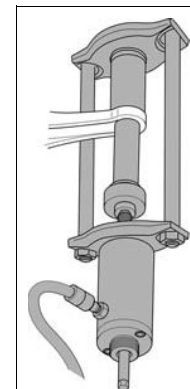

### Note:

For the storage system for the KL-0039-Series please refer to chapter 10.

## KL-0039-160 Press-/Support Sleeve Set Ø 30-90 mm (short) 45 mm

Designed to press in and press out silentblocs, shafts, bushes etc. in conjunction with the tools of the **KL-0039-... Series**.



2

### Scope of Delivery:

#### KL-0039-160 Press-/Support Sleeve Set Ø30 - 90 mm, short (Length: 45 mm)

Part No.	Description	Qty.
KL-0039-1630	Press-/Support sleeve, short 30/Ø22	1
KL-0039-1632	Press-/Support sleeve, short Ø32/Ø24	1
KL-0039-1634	Press-/Support sleeve, short Ø34/Ø26	1
KL-0039-1636	Press-/Support sleeve, short Ø36/Ø28	1
KL-0039-1638	Press-/Support sleeve, short Ø38/Ø30	1
KL-0039-1640	Press-/Support sleeve, short Ø40/Ø32	1
KL-0039-1642	Press-/Support sleeve, short Ø42/Ø34	1
KL-0039-1644	Press-/Support sleeve, short Ø44/Ø36	1
KL-0039-1646	Press-/Support sleeve, short Ø46/Ø38	1
KL-0039-1648	Press-/Support sleeve, short Ø48/Ø40	1
KL-0039-1650	Press-/Support sleeve, short Ø50/Ø42	1
KL-0039-1652	Press-/Support sleeve, short Ø52/Ø44	1
KL-0039-1654	Press-/Support sleeve, short Ø54/Ø46	1
KL-0039-1656	Press-/Support sleeve, short Ø56/Ø48	1
KL-0039-1658	Press-/Support sleeve, short Ø58/Ø50	1
KL-0039-1660	Press-/Support sleeve, short Ø60/Ø52	1

Part No.	Description	Qty.
KL-0039-1662	Press-/Support sleeve, short Ø62/Ø54	1
KL-0039-1664	Press-/Support sleeve, short Ø64/Ø56	1
KL-0039-1666	Press-/Support sleeve, short Ø66/Ø58	1
KL-0039-1668	Press-/Support sleeve, short Ø68/Ø60	1
KL-0039-1670	Press-/Support sleeve, short Ø70/Ø62	1
KL-0039-1672	Press-/Support sleeve, short Ø72/Ø64	1
KL-0039-1674	Press-/Support sleeve, short Ø74/Ø66	1
KL-0039-1676	Press-/Support sleeve, short Ø76/Ø68	1
KL-0039-1678	Press-/Support sleeve, short Ø78/Ø70	1
KL-0039-1680	Press-/Support sleeve, short Ø80/Ø72	1
KL-0039-1682	Press-/Support sleeve, short Ø82/Ø74	1
KL-0039-1684	Press-/Support sleeve, short Ø84/Ø76	1
KL-0039-1686	Press-/Support sleeve, short Ø86/Ø78	1
KL-0039-1688	Press-/Support sleeve, short Ø88/Ø80	1
KL-0039-1690	Press-/Support sleeve, short Ø90/Ø82	1

## KL-0039-170 Press-/Support Sleeve Set Ø 30-90 mm (long) 115 mm

Designed to press in and press out silentblocs, shafts, bushes etc. in conjunction with the tools of the **KL-0039-... Series**.

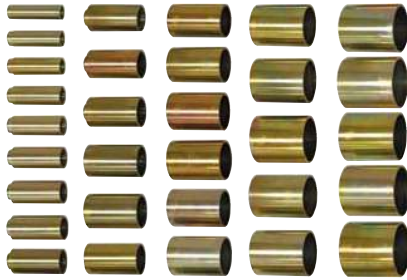

### Scope of Delivery:

#### KL-0039-170 Press-/Support Sleeve Set Ø 30-90 mm (long) 115 mm

Part No.	Description	Qty.
KL-0039-1730	Press-/Support sleeve, long Ø30/Ø22	1
KL-0039-1732	Press-/Support sleeve, long Ø32/Ø24	1
KL-0039-1734	Press-/Support sleeve, long Ø34/Ø26	1
KL-0039-1736	Press-/Support sleeve, long Ø36/Ø28	1
KL-0039-1738	Press-/Support sleeve, long Ø38/Ø30	1
KL-0039-1740	Press-/Support sleeve, long Ø40/Ø32	1
KL-0039-1742	Press-/Support sleeve, long Ø42/Ø34	1
KL-0039-1744	Press-/Support sleeve, long Ø44/Ø36	1
KL-0039-1746	Press-/Support sleeve, long Ø46/Ø38	1
KL-0039-1748	Press-/Support sleeve, long Ø48/Ø40	1
KL-0039-1750	Press-/Support sleeve, long Ø50/Ø42	1
KL-0039-1752	Press-/Support sleeve, long Ø52/Ø44	1
KL-0039-1754	Press-/Support sleeve, long Ø54/Ø46	1
KL-0039-1756	Press-/Support sleeve, long Ø56/Ø48	1
KL-0039-1758	Press-/Support sleeve, long Ø58/Ø50	1
KL-0039-1760	Press-/Support sleeve, long Ø60/Ø52	1

Part No.	Description	Qty.
KL-0039-1762	Press-/Support sleeve, long Ø62/Ø54	1
KL-0039-1764	Press-/Support sleeve, long Ø64/Ø56	1
KL-0039-1766	Press-/Support sleeve, long Ø66/Ø58	1
KL-0039-1768	Press-/Support sleeve, long Ø68/Ø60	1
KL-0039-1770	Press-/Support sleeve, long Ø70/Ø62	1
KL-0039-1772	Press-/Support sleeve, long Ø72/Ø64	1
KL-0039-1774	Press-/Support sleeve, long Ø74/Ø66	1
KL-0039-1776	Press-/Support sleeve, long Ø76/Ø68	1
KL-0039-1778	Press-/Support sleeve, long Ø78/Ø70	1
KL-0039-1780	Press-/Support sleeve, long Ø80/Ø72	1
KL-0039-1782	Press-/Support sleeve, long Ø82/Ø74	1
KL-0039-1784	Press-/Support sleeve, long Ø84/Ø76	1
KL-0039-1786	Press-/Support sleeve, long Ø86/Ø78	1
KL-0039-1788	Press-/Support sleeve, long Ø88/Ø80	1
KL-0039-1790	Press-/Support sleeve, long Ø90/Ø82	1



## Hydraulic Press Tool (17t) VW-T4

KL-0043-861

**Suitable for VW T4 front axle upper guide ball-joint.**

The upper ball-joint may be removed and replaced within 30 minutes using the new Press Tool **KL-0043-861**, without the need to dismantle the upper wishbone.

**Advantages**

- Large time savings (2 - 3 hours).
- Simple and precise to use.

**Scope of Delivery: KL-0043-861 Hydraulic Press Tool (17t)**

Part No.	Description	Qty.
KL-0043-8610	Press Frame	1
<b>KL-0043-8691</b>	<b>Set of Sleeves VW-T4</b>	<b>1</b>
KL-0215-10	Hydraulic Cylinder 17t with pressure spindle; pin Ø18 mm	1

**Scope of Delivery: KL-0043-860 Press Tool Set VW-T4**

Part No.	Description	Qty.
<b>KL-0043-8610</b>	<b>Press frame</b>	<b>1</b>
<b>KL-0043-8691</b>	<b>Sleeve set VW-T4</b>	<b>1</b>

**Scope of Delivery: KL-0043-8610 Press Frame**

Part No.	Description	Qty.
KL-0039-1144	Base Plate 2 1/4"-14 UNS	1
KL-0043-8501-V	Base Plate 2 1/4"-14 UNS (reinforced design)	1
KL-0215-4004	Tie rods (frame)	1
KL-0049-3004	Hex nut M18	2
KL-0043-8601	Adaptor 2 1/4"-14UNS to Ø60 mm	4

**Scope of Delivery: KL-0043-8691 Sleeve Set VW-T4**

Part No.	Description	Qty.
KL-0043-8661	Lower Sleeve VW-T4	1
KL-0043-8501-V	Upper Sleeve VW-T4	1

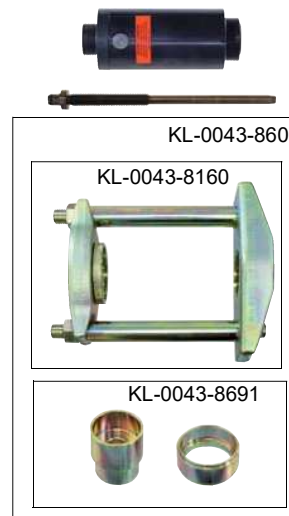

2

## Upgrade Kit VW T4 for Pulling Device KL-0215-4... Series

KL-0043-8611

**Suitable for VW T4 front axle upper guide joint.**

The upgrade kit **KL-0043-8611** allows the pulling device for silentblos of the **KL-0215-4... Series** also to be used to replace the upper guide joint on the front axle of VW T4.

**Scope of Delivery: KL-0043-8611 Upgrade Kit VW T4 for Pulling Device KL-0215-4... Series**

Part No.	Description	Qty.
KL-0043-8501-V	Base Plate 2 1/4"-14 UNS reinforced	1
KL-0043-8601	Adaptor 2 1/4"-14UNS to Ø60	1
KL-0043-8691	Sleeve Set VW-T4	1



## Press Tool Set (short), BMW E36, with Hydraulic Cylinder

KL-0039-762

**Suitable for BMW 3-Series (E36) front axle wishbone.**

The tool set **KL-0039-762** enables quick and trouble-free removal and installation of the outer suspension ball joint on the lower wishbone.

The removal and replacement of the outer suspension ball joint can be performed directly on the vehicle within a few minutes, without the need to remove the wishbone from the vehicle.

**Scope of Delivery: KL-0039-762 Press Tool Set (short), BMW E36, with Hydr. Cyl.**

Part No.	Description	Qty.
<b>KL-0039-7620</b>	<b>Press Tool Set (short), BMW E36, without drive</b>	<b>1</b>
KL-0040-2500	Hydraulic Cylinder 17t	1

**Scope of Delivery: KL-0039-7620 Press Tool Set (short), BMW E36, without drive**

Part No.	Description	Qty.
<b>KL-0039-7623</b>	<b>Sleeve Set (short), BMW E36</b>	<b>1</b>
KL-0039-1140	Press Frame (short)	1
KL-0039-1002	Retainer Adaptor for clamping nut and pressure spindle with O-ring	1
KL-0039-1930	Pressure spindle M20x350 with O-ring	1

**Scope of Delivery: KL-0039-7623 Set of Sleeves (short) BMW E36**

Part No.	Description	Qty.
KL-0043-8288-1	Press sleeve for BMW E36	1
KL-0043-8289-1	Support sleeve for BMW E36	1
KL-0039-1648	Press-/Support sleeve (short) Ø48 mm	1
KL-0039-1658	Press-/Support sleeve (short) Ø58 mm	1



**KL-0326-10 A Hydraulic Press Tool Set**
**(German Utility Model)**
**2**

Suitable for Mercedes W163 (M-Class, front- / rear axle), W211 (E-Class 2002 onwards, front axle), W219 (CLS, front axle), W220 (S-Class, front axle), W230 (SL, front axle), W124 (E-Class, front axle) and W201 (190-Series, front axle).

The hydraulic press tool set **KL-0326-10 A** allows the suspension ball joint to be quickly and easily pressed into and out of the lower wishbone. The suspension ball joint can often be removed or installed directly on the vehicle within a few minutes, without having to dismount the wishbone.

**Scope of Delivery: KL-0326-10 A Hydraulic Press Tool Set**

Part No.	Description	Qty.
KL-0326-100 A	Hydraulic Press Frame	1
KL-0326-112 A	Set of Sleeves (W163 / W211 / W219 / W220 / W230)	1
KL-0326-131 A	Set of Sleeves (W124 / W201)	1

**Scope of Delivery: KL-0326-100 A Hydraulic Press Frame**

Part No.	Description	Qty.
KL-0326-1000	Press frame	1
KL-0040-2500	Hydraulic Cylinder 17t	1
KL-0039-1930	Pressure spindle M20x350 with O-ring	1

**Scope of Delivery: KL-0326-1000 Press Frame**

Part No.	Description	Qty.
KL-0326-1001	Press frame	1
KL-0326-1002	Guide rail	1
KL-0326-1003	Hexagon socket screw M12 x 20	2

**Scope of delivery: KL-0326-101 A Hydraulic press tool set suspension ball joint MB without drive**

Part No.	Description	Qty.
KL-0326-1000	Press Frame	1
KL-0326-112 A	Set of Sleeves (W163 / W211 / W219 / W220 / W230)	1
KL-0326-131 A	Set of Sleeves W124 / W201	1

**Scope of Delivery: KL-0326-131 A Set of Sleeves (W124 / W201)**

Part No.	Description	Qty.
KL-0326-1311	Adaptor ring 3 with O-ring	1
KL-0326-1312	Adaptor ring 4 with O-ring	1
KL-0326-1313 A	Press piece (removal)	1
KL-0326-1314	Press piece (removal)	1

**Scope of Delivery: KL-0326-112 A Set of Sleeves (W163 / W211 / W219 / W220 / W230)**

Part No.	Description	Qty.
KL-0326-1111	Adaptor ring 1 with O-ring	1
KL-0326-1211	Adaptor ring 2 with O-ring	1
KL-0039-1634	Press/Support sleeve short Ø34	1
KL-0039-1642	Press/Support sleeve short Ø42	1
KL-0039-1650	Press/Support sleeve short Ø50	1
KL-0326-1313 A	Press piece (removal)	1

**KL-0326-11 A Hydraulic Press Tool W163**
**(German Utility Model)**

Suitable for Mercedes M-Class (W163).

The hydraulic press tool set **KL-0326-11 A** allows the suspension ball joint to be quickly and easily pressed into and out of the lower wishbone. The suspension ball joint can often be removed or installed directly on the vehicle within a few minutes, without having to dismount the wishbone.

**Scope of Delivery: KL-0326-11 A Hydraulic Press Tool W163**

Part-No.	Description	Qty.
KL-0326-111 A	Set of Sleeves (W163)	1
KL-0326-1000	Press Frame	1
KL-0040-2500	Hydraulic Cylinder 17 t.	1
KL-0039-1930	Pressure spindle M20x350 with O-ring	1

**Scope of Delivery: KL-0326-111 A Set of Sleeves (W163)**

Part-No.	Description	Qty.
KL-0326-1111	Adaptor ring 1 with O-ring	1
KL-0039-1642	Press/Support sleeve short Ø42	1
KL-0326-1313 A	Press piece (removal)	1

## Hydraulic Press Tool Set W211 / W219 / W220 / W230

(German Utility Model)

KL-0326-12 A

Suitable for Mercedes E-Class (W211), CLS (W219), S-Class (W220) SL (W230).

The suspension ball joint can easily and quickly be pressed into and out of the lower wishbone with the press tool set **KL-0326-12 A**. The ball joint can often be removed or installed directly on the vehicle within a few minutes, without having to dismount the wishbone.

## Scope of Delivery: KL-0326-12 A Hydraulic Press Tool Set

Part No.	Description	Qty.
KL-0326-121 A	Set of Sleeves (W211 / W219 / W220 / W230)	1
KL-0326-1000	Press frame	1
KL-0040-2500	Hydraulic cylinder 17t	1
KL-0039-1930	Pressure spindle M20x350 with O-ring	1

## Scope of Delivery: KL-0326-121 A Set of Sleeves

Part No.	Description	Qty.
KL-0326-1111	Adaptor ring 1 with O-ring	1
KL-0326-1211	Adaptor ring 2 with O-ring	1
KL-0039-1634	Press/Support sleeve short Ø34	1
KL-0039-1650	Press/Support sleeve short Ø50	1

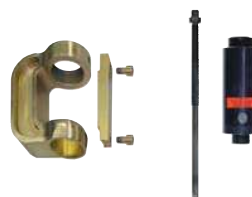

KL-0326-121 A



2

## Hydraulic Press Tool Set W124 / W201

(German Utility Model)

KL-0326-13 A

Suitable for Mercedes W124, W201 (190 series).

The suspension ball joint can easily and quickly be pressed into and out of the lower wishbone with the press tool set **KL-0326-13 A**. The ball joint can often be removed or installed directly on the vehicle within a few minutes, without having to dismount the wishbone.

## Scope of Delivery: KL-0326-13 A Hydraulic Press Tool Set

Part No.	Description	Qty.
KL-0326-131 A	Set of Sleeves (W124 / W201)	1
KL-0326-1000	Press frame	1
KL-0040-2500	Hydraulic cylinder 17t	1
KL-0039-1930	Pressure spindle M20x350 with O-ring	1

## Scope of Delivery: KL-0326-131 A Set of Sleeves

Part No.	Description	Qty.
KL-0326-1311	Adaptor ring 3 with O-ring	1
KL-0326-1312	Adaptor ring 4 with O-ring	1
KL-0326-1313 A	Press piece (removal)	1
KL-0326-1314	Press piece (removal)	1



KL-0326-131 A



## Toothed Socket

KL-0326-20

Suitable for Mercedes M-Class (W163)

For tightening the suspension ball joint fastening nut on the steering knuckle.

## Technical Data:

Outer diameter:	63.0 mm
Inner diameter:	52.5 mm
Tooth Width:	7.5 mm
Weight:	500 g



## Hydraulic Press Tool (17t.)

KL-0626-10

Suitable for Ford Transit 2002 onwards front axle.

The support ball joint can be pressed out of or into the wheel bearing housing quickly and without any difficulty by using press tool set **KL-0626-10**. The support ball joint can be removed or installed in-situ on the vehicle within just a few minutes, without the wheel bearing housing having to be removed.

## Scope of Delivery: KL-0626-10 Hydraulic Press Tool (17t.)

Part No.	Description	Qty.
KL-0626-100	Press Tool without Hydraulic Cylinder	1
KL-0040-2500	Hydraulic Cylinder 17t.	1
KL-0040-2510	Press Spindle	1

## Scope of Delivery: KL-0626-100 Hydraulic Press Tool without Hydr. Cyl.

Part No.	Description	Qty.
KL-0626-1001	Press Frame	1
KL-0626-1002	Collar screw	1
KL-0174-559	Adaptor 2 1/4"-14UNS to 2 1/4"-14UNS	1
KL-0626-1003	Press piece (removal) Ø: 38 mm	1
KL-0626-1004	Support sleeve (removal) Ø: 66.5mm	1
KL-0626-1005	Support sleeve (replacement) Ø: 54mm	1
KL-0626-1006	Press piece (replacement) Ø: 56mm	1



KL-0626-100

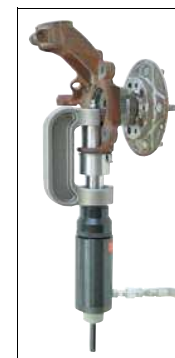

**KL-0039-750****Press Tool Set with hydraulic cylinder****(Pat. e.g. US-Patent 7,020,944)**

**Suitable for changing suspension ball joints on Mercedes Sprinter (904) models '95 onwards and VW LT (2D) models '96 onwards.**

The Press Tool Set **KL-0039-750** in conjunction with the Hydraulic Pump **KL-0215-35 M25** or **KL-0215-37 M25** enables quick and trouble-free pushing out and pressing in of ball joints on the lower wishbone. Replacement of a ball joint can be performed directly on the vehicle within a few minutes, without having to remove the wishbone from the vehicle.



**Note:** Two different wishbones with two different ball joints are used on Mercedes Sprinter and VW LT.

**Scope of Delivery:****KL-0039-750 Press Tool Set with hydraulic cylinder**

Part-No.	Description	Qty.
<b>KL-0039-7500</b>	<b>Press Tool Set without hydraulic cylinder</b>	<b>1</b>
KL-0040-2500	Hydraulic Cylinder 17 t	1

**Scope of Delivery:****KL-0039-7500 Press Tool Set without hydraulic cylinder**

Part No.	Description	Qty.
<b>KL-0039-7503</b>	<b>Sleeve Set short MB Sprinter</b>	<b>1</b>
KL-0039-1140	Press frame, short	1
KL-0039-1002	Retainer Adaptor for clamping nut and pressure spindle with O-ring	1
KL-0039-1930	Pressure spindle M20x350 mm with O-ring	1

**Scope of Delivery:****KL-0039-7503 Sleeve Set short MB Sprinter**

Part No.	Description	Qty.
KL-0039-1823	Support Sleeves with clamping disc for MB Sprinter	1
KL-0039-1662	Press-/Support sleeve short Ø62 mm	1
KL-0039-1762	Press-/Support sleeve long Ø62 mm	1
KL-0043-8531	Press sleeve	1



Ball joint extraction



Ball joint insertion

**KL-0039-752****Press Tool Set (short), MB, with hydr. cylinder**

**Suitable for Mercedes 190-Series (W201) W124 and W129 suspension ball joint on the front lower wishbone.**

The press tool set **KL-0039-752** used in conjunction with a hydraulic pump such as **KL-0215-35 M25** enables a suspension ball joint to be quickly and easily pressed into and pressed out of the lower wishbone. Removal and installation of a suspension ball joint can be carried out directly on the vehicle within a few minutes without the need to remove the wishbone from the vehicle.

**Scope of Delivery:****KL-0039-752 Press Tool Set (short), MB, with hydr. cylinder**

Part-No.	Description	Qty.
<b>KL-0039-7520</b>	<b>Press Tool Set (short), MB, without drive</b>	<b>1</b>
KL-0040-2500	Hydraulic cylinder 17t	1

**Scope of Delivery:****KL-0039-7520 Press Tool Set (short), MB, without drive**

Part-No.	Description	Qty.
<b>KL-0039-7523</b>	<b>Sleeve Set (short) MB</b>	<b>1</b>
KL-0039-1140	Press Frame (short)	1
KL-0039-1002	Retainer Adaptor for clamping nut and pressure spindle with O-ring	1
KL-0039-1930	Pressure spindle M20x350 with O-ring	1

**Scope of Delivery:****KL-0039-7523 Sleeve Set (short) MB**

Part-No.	Description	Qty.
KL-0039-1636	Press-/Support sleeve, short Ø36 mm	1
KL-0039-1658	Press-/Support sleeve, short Ø58 mm	1
KL-0039-1760	Press-/Support sleeve, long Ø60 mm	1





## Press Tool Set (short) with hydraulic cylinder

KL-0039-710

Suitable for Renault Master II ('98 onwards) and Opel/Vauxhall Movano I ('98 onwards).

The Press Tool **KL-0039-710** in conjunction with the Hydraulic Pump **KL-0215-35 M25** or **KL-0215-37 M25** allows quick, professional and safe removal and replacement of ball joints on the front upper and lower wishbone. This tool enables even heavily corroded ball joints to be pressed in and pushed out within a few minutes.

The removal of the upper or lower wishbone is not necessary.

**Advantages:**

- Substantial time savings of approx. 1 to 2 hours
- Quick and professional pressing out and pressing in of ball joints
- Hydraulic cylinder 17t **KL-0040-2500** can be used on other KLANN tools to exert thrust or compression force

**Scope of Delivery:****KL-0039-710 Press Tool Set with hydraulic cylinder**

Part-No.	Description	Qty.
KL-0039-7100	Press Tool Set without hydraulic cylinder	1
KL-0040-2500	Hydraulic cylinder 17 t	1

**Scope of Delivery:****KL-0039-7100 Press Tool Set without hydraulic cylinder**

Part-No.	Description	Qty.
KL-0039-1140	Press frame, short	1
KL-0039-1930	Pressure spindle M20x350 with O-Ring	1
KL-0039-1002	Retainer Adaptor for clamp nut and pressure spindle	1
KL-0039-712	Pressure- / Support Sleeve Set Renault Master / Opel Movano	1

**Scope of Delivery:****KL-0039-712 Pressure- / Support Sleeve Set**

Part-No.	Description	Qty.
KL-0039-722	Sleeve Set upper suspension ball joint	1
KL-0039-732	Sleeve Set lower suspension ball joint	1

**Scope of Delivery:****KL-0039-722 Sleeve Set (short) upper suspension ball joint**

Part No.	Description	Qty.
KL-0039-1644	Press- / Support Sleeve short Ø 44 mm	1
KL-0039-1764	Press- / Support Sleeve long Ø 64 mm	1
KL-0039-1820	Support Sleeve	1
KL-0039-1758	Pressure- / Support Sleeve long Ø 58 mm	1

**Scope of Delivery:****KL-0039-732 Sleeve Set (short) upper suspension ball joint**

Part-No.	Description	Qty.
KL-0039-1821	Press- / Support Sleeve	1
KL-0039-1658	Press- / Support Sleeve short Ø 58 mm	1
KL-0039-1652	Press- / Support Sleeve short Ø 52 mm	1
KL-0039-1822	Press- / Support Sleeve	1

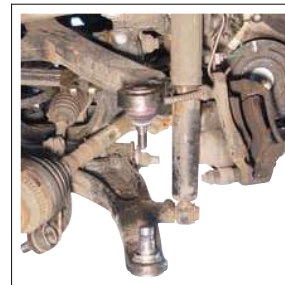
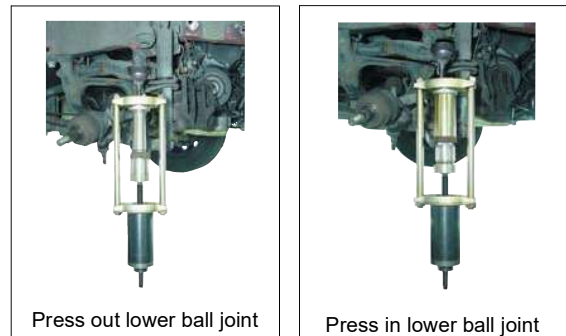
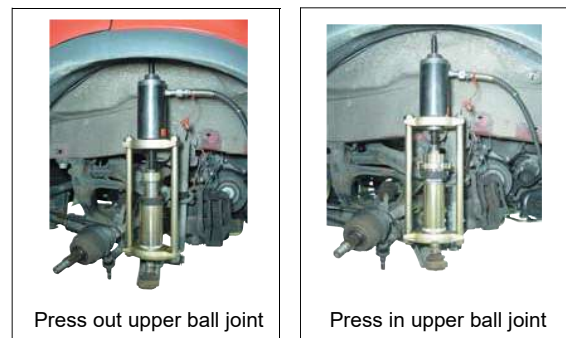

**KL-0039-720****Press Tool Set with Hydraulic Cylinder Renault Master / Vauxhall/Opel Movano**

Press out upper ball joint



Press in upper ball joint

**Suitable for Renault Master II ('98 onwards) and Opel/Vauxhall Movano I ('98 onwards).**

The press tool set **KL-0039-720** used in conjunction with the hydraulic pump **KL-0215-35 M25** or **KL-0215-37 M25** allows quick, professional and safe removal and replacement of suspension ball joints on the front upper wishbone. This tool enables even heavily corroded suspension ball joints to be pressed in and pushed out within just a few minutes.

The removal of the upper wishbone is not necessary.

**Scope of Delivery:****KL-0039-720 Press Tool Set with Hydraulic Cylinder**

Part-No.	Description	Qty.
KL-0039-721	Press Tool Set without hydraulic cylinder Renault Master / Opel Movano	1
KL-0040-2500	Hydraulic cylinder 17 t	1

**Scope of Delivery:****KL-0039-721 Press Tool Set without Hydraulic Cylinder**

Part-No.	Description	Qty.
KL-0039-1140	Press Frame, short	1
KL-0039-1930	Retainer Adaptor for clamp nut and pressure spindle	1
KL-0039-1002	Pressure spindle M20x350 with O-Ring	1
KL-0039-722	Sleeve Set upper suspension ball joint	1

**Scope of Delivery:****KL-0039-722 Sleeve Set upper suspension ball joint**

Part No.	Description	Qty.
KL-0039-1644	Press- / Support Sleeve short Ø 44 mm	1
KL-0039-1764	Press- / Support Sleeve long Ø 64 mm	1
KL-0039-1820	Support Sleeve Master / Movano	1
KL-0039-1758	Pressure- / Support Sleeve long Ø 58 mm	1

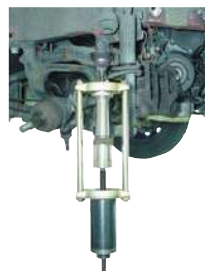
**KL-0039-730****Press Tool Set with hydraulic cylinder, Renault Master / Opel/Vauxhall Movano**

Press out lower ball joint

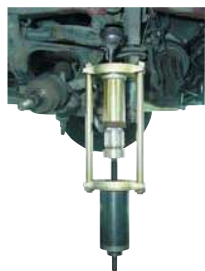

Press in lower ball joint

**Suitable for Renault Master II ('98 onwards) and Opel Movano I ('98 onwards).**

The Press Tool **KL-0039-730** in conjunction with the Hydraulic Pump **KL-0215-35 M25** or **KL-0215-37 M25** allows quick, professional and safe removal and replacement of ball joints on the front lower wishbone.

This tool enables even heavily corroded ball joints to be pressed in and pushed out within a few minutes.

The removal of the lower wishbone is not necessary.

**Scope of Delivery:****KL-0039-730 Press Tool Set with hydraulic cylinder, Renault Master / Opel/Vauxhall Movano**

Part-No.	Description	Qty.
KL-0039-731	Press Tool Set without hydraulic cylinder Renault Master / Opel/Vauxhall Movano	1
KL-0040-2500	Hydraulic cylinder 17 t	1

**Scope of Delivery:****KL-0039-731 Press Tool Set without Hydraulic Cylinder Renault Master / Opel/Vauxhall Movano**

Part-No.	Description	Qty.
KL-0039-1140	Press Frame, short	1
KL-0039-1930	Pressure spindle	1
KL-0039-1002	Retainer Adaptor for clamp nut and pressure spindle	1
KL-0039-732	Sleeve Set (short) lower wishbone	1

**Scope of Delivery:****KL-0039-732 Sleeve Set (short) lower suspension ball joint**

Part-No.	Description	Qty.
KL-0039-1821	Press- / Support Sleeve	1
KL-0039-1658	Press- / Support Sleeve short Ø 58 mm	1
KL-0039-1652	Press- / Support Sleeve short Ø 52 mm	1
KL-0039-1822	Press- / Support Sleeve	1

**Pulling Device with Hydraulic Cylinder**

(Pat.)

**KL-1210-2**

**Suitable for Renault Master II ('98 onwards) and Opel/Vauxhall Movano I ('98 onwards)**

The pulling device **KL-1210-2** is designed for the professional removal and replacement of the two silentbloks on the lower wishbone.

**Scope of Delivery:****KL-1210-2 Pulling Device with Hydraulic Cylinder**

Part No.	Description	Qty.
KL-0040-2500	Hydraulic Cylinder 17 t.	1
KL-0039-1003	Retainer adaptor for hydr. cyl. with O-ring	1
KL-0039-1002	Retainer adaptor for clamp nut and pressure spindle with O-ring	1
KL-1210-200	Pulling Device without Hydraulic cylinder 17 t.	1

**Scope of Delivery:****KL-1210-200 Pulling Device without Hydraulic Cylinder**

Part No.	Description	Qty.
KL-0039-1914	Pull spindle M14 with nut	1
KL-1210-201	Press/support sleeve set	1

**Scope of Delivery:****KL-1210-201 Press/Support Sleeve Set Renault Master/Opel Movano**

Part No.	Description	Qty.
KL-1210-2001	Support sleeve	1
KL-1210-2002	Pressure piece	1
KL-1210-2003	Support sleeve	1
KL-1210-2004	Pressure piece	1
KL-1210-2005	Pressure piece	1

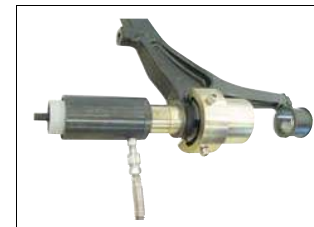
**Press Tool Set with hydraulic cylinder****KL-0711-11 L**

**Suitable for Volvo S40 / V40 front axle wishbone.**

For quick and easy removal and replacement of suspension ball joints.

The ball joint can be removed and installed directly on the vehicle within a few minutes without having to dismount the wishbone.

This tool enables even heavily corroded ball joints to be pushed out and pressed in within a few minutes.

**Scope of Delivery:****KL-0711-11 L Press Tool Set with hydraulic cylinder**

Part No.	Description	Qty.
KL-0711-110 L	Press Tool Set without hydraulic cylinder	1
KL-0040-2500	Hydraulic cylinder 17t	1

**Scope of Delivery:****KL-0711-110 L Press Tool Set without hydraulic cylinder**

Part No.	Description	Qty.
KL-0039-1140	Press Frame, short	1
KL-0711-111	Sleeve Set	1
KL-0039-1002	Retainer Adaptor for clamping nut and pressure spindle	1
KL-0039-1930	Pressure spindle M20 x 350 mm with O-ring	1

**Scope of Delivery:****KL-0711-111 Sleeve Set**

part-No.	Description	Qty.
KL-0711-1111	Press Sleeve short Ø38 mm	1
KL-0039-1754	Press-/Support Sleeve long Ø54 mm	1
KL-0039-1750	Press-/Support Sleeve long Ø50 mm	1
KL-0039-1654	Press-/Support Sleeve short Ø54 mm	1

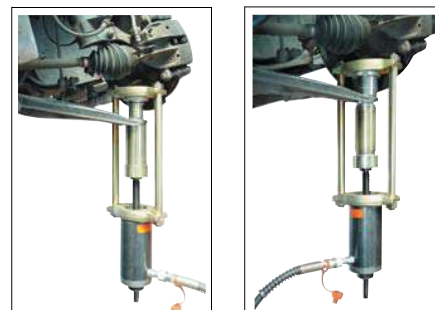

Application list: KL-0039-... Press- / Support sleeves if the KLANN Press frame is already available

2

\* = short  
\*\* = long

Frame

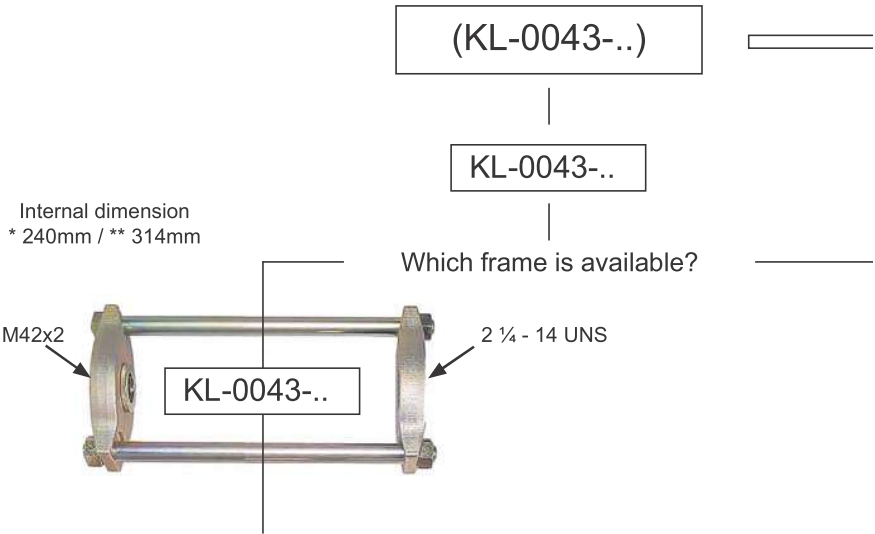

Drive

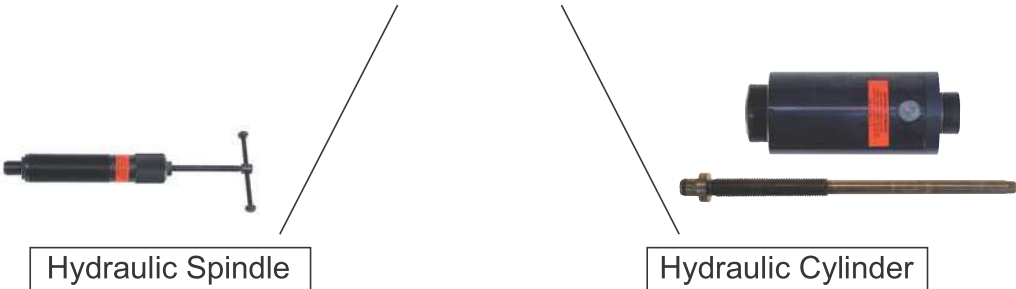

Adaptor

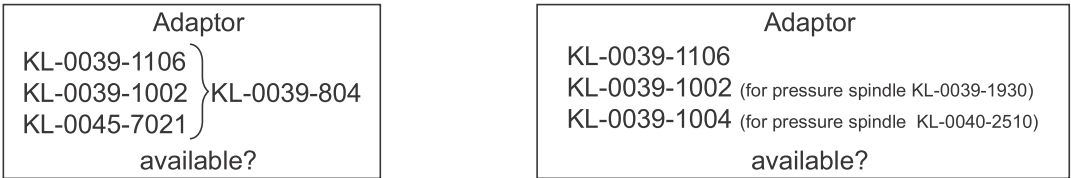

Sleeve sets

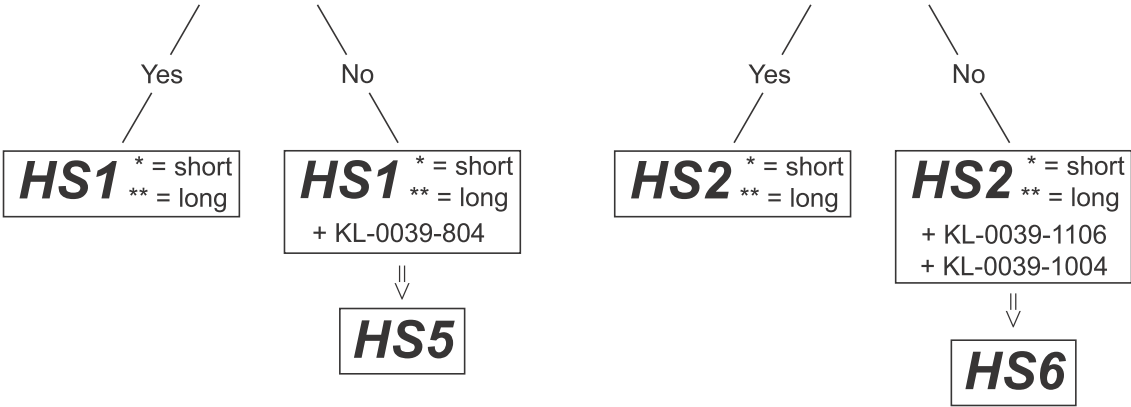

**Note:**  
For pressure spindle  
KL-0039-1930  
use HS2, KL-0039-1106  
+ KL-0039-1002



Application list: KL-0039-... Press- / Support sleeves if the KLANN Press frame is already available

⇒ **P1** (KL-0039-..)

KL-0039-..

Internal dimension  
\* 275mm / \*\* 350mm

2 ¼ - 14 UNS

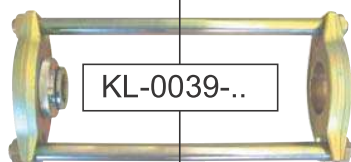

2 ¼ - 14 UNS

KL-0039-..

**Frame**

Which drive is available?



Hydraulic Spindle



Hydraulic Cylinder

**Drive**

Adaptor  
KL-0039-1002  
KL-0045-7021  
available?

Yes

No

**HS3** \* = short  
\*\* = long

**HS3** \* = short  
\*\* = long  
+ KL-0039-1002  
+ KL-0045-7021

Adaptor  
KL-0039-1002 (for pressure spindle KL-0039-1930)  
available?

Yes

No

**HS4** \* = short  
\*\* = long

**HS4** \* = short  
\*\* = long  
+ KL-0039-1002

**Adaptor**

**Sleeve sets**

**Note:** For individual components please refer to chapter 4.

## Universal Press Tool Sets

KL-0043- ... Series	
KL-0043-82	Press Tool Set Univ.
KL-0043-820	Press Tool Kit without drive
KL-0043-83	Press Tool Set Univ. (short)
KL-0043-85	Press Tool Set Univ. (short)
KL-0043-850	Press Tool Kit without drive (short)

KL-0039-... Series		
P1	KL-0039-910 H	Press Tool Set (long) with hydraulic spindle
P1	KL-0039-931 H	Press Tool Set (short) without drive (alternatively)
P1	KL-0039-920 H	Press Tool Set (short) with hydraulic spindle
P1	KL-0039-930 H	Press Tool Set (short) with hydraulic cylinder 17 t
P1	KL-0039-931 H	Press Tool Set (short) without drive

## Universal Sleeve Sets

KL-0043- ... Series	
KL-0043-8295	Press Tube Set long
KL-0043-8595	Press Tube Set short

KL-0039-... Series		
	KL-0039-1701	Press / Support Sleeve Set (long)
	KL-0039-1601	Press / Support Sleeve Set (short)

## Vehicle-specific Press Tool Sets

KL-0043- ... Series	
<b>Mercedes</b>	
KL-0043-822	Press Tool with Hydraulic Spindle MB W124, W129 and W201
KL-0043-8292	Press/Support Tube Set long MB W124, W129 und W201
KL-0043-854	Press Tool with Hydraulic Cylinder 17t, short MB W124, W129 and W201
KL-0043-8592	Press/Support Tube Set short MB W124, W129 and W201
KL-0043-855 C	Press Tool with hydraulic cylinder short MB Sprinter
KL-0043-8591C	Press / Support Sleeve Set short MB Sprinter

KL-0039-... Series		
P1	KL-0039-751	Press Tool Set (long) MB with hydraulic spindle
	KL-0039-7510	Press Tool Set (long) MB without drive
HS1**	KL-0039-7514	Sleeve Set (long) MB (for KL-0043-82..)
HS2** HS3** HS4**	KL-0039-7513	Sleeve Set (long) MB
HS5**	KL-0039-7512	Sleeve Set (long) MB, with adaptor (for KL-0043-82 with hydr. spindle)
HS6**	KL-0039-7511	Sleeve Set (long) MB with adaptor (for KL-0043-82..)
P1	KL-0039-752	Press Tool Set (short) MB with hydraulic cylinder 17 t
	KL-0039-7520	Press Tool Set (short) MB without drive
HS1*	KL-0039-7524	Sleeve Set (short) MB (for KL-0043-85..)
HS2* HS3* HS4*	KL-0039-7523	Sleeve Set (short) MB
HS5*	KL-0039-7522	Sleeve Set (short) MB with adaptor (for KL-0043-85.. with hydr. spindle)
HS6*	KL-0039-7521	Sleeve Set (short) MB with adaptor (for KL-0043-85..)
P1	KL-0039-750	Press Tool Set (short) MB Sprinter with hydr. cyl.
	KL-0039-7500	Press Tool Set (short) MB Sprinter without drive
HS2* HS3* HS4*	KL-0039-7503	Sleeve Set (short) MB Sprinter
HS6*	KL-0039-7501	Sleeve Set (short) MB Sprinter with adaptor (for KL-0043-85..)



## KL-0043- ... Series

### BMW

KL-0043-823	Press Tool with Hydraulic Spindle BMW E36
KL-0043-8294	Press /Support Sleeve Set long BMW E36

KL-0043-823 A	Press Tool with Hydraulic Spindle 12 t BMW E36
KL-0043-8294 A	Press / Support Sleeve Set long BMW E36

KL-0043-859	
KL-0043-8594	Press / Support Sleeve Set short BMW E36

KL-0043-8296	Press / Support Sleeve Set long BMW E30

## KL-0043- ... Series

### Renault

KL-0043-829	Press Tool Set with hydraulic cylinder 17 t; Renault Master
KL-0043-8290 A	Press Tool Set without hydraulic cylinder; Renault Master, Vauxhall / Opel Movano
KL-0043-8298	Press /Support Sleeve Set; Renault Master, Vauxhall / Opel Movano upper ball joint
KL-0043-8101	Press /Support Sleeve Set; Renault Master, Vauxhall / Opel Movano lower ball joint
KL-0043-810	Press Tool with hydr.cylinder Renault Master/Opel Movano
KL-0043-8101	Press / Support Sleeve Set Renault Master/Opel Movano, lower suspension ball joint

## KL-0043- ... Series

### Volvo

## KL-0039-... Series

P1	KL-0039-760	Press Tool Set (long) BMW E36 with hydr. spindle
	KL-0039-7600	Press Tool Set (long) BMW E36 without drive
HS1**	KL-0039-7604	Sleeve Set (long) BMW E36, (for KL-0043-82..)
HS2**	KL-0039-7603	Sleeve Set (long) BMW E36
HS3**		
HS4**		
HS5**	KL-0039-7602	Sleeve Set (long) BMW E36 with adaptor (for KL-0043-82.. with hydr. spindle)
HS6**	KL-0039-7601	Sleeve Set (long) BMW E36 with adaptor (for KL-0043-82..)

P1	KL-0039-761	Press Tool Set (long) BMW E36 with hydr. spindle
	KL-0039-7610	Press Tool Set (long) BMW E36 without drive
HS1**	KL-0039-7614	Sleeve Set (long) BMW E36 (for KL-0043-82..)
HS2**		
HS3**	KL-0039-7613	Sleeve Set (long) BMW E36
HS4**		
HS5**	KL-0039-7612	Sleeve Set (long) BMW E36 with adaptor (for KL-0043-82.. with hydr. spindle)
HS6**	KL-0039-7611	Sleeve Set (long) BMW E36 with adaptor (for KL-0043-82..)

P1	KL-0039-762	Press Tool Set (short) BMW E36 with hydr. cylinder
	KL-0039-7620	Press Tool Set (short) BMW E36 without drive
HS1*	KL-0039-7623	Sleeve Set (short) BMW E36
HS2*		
HS3*		
HS4*		
HS5*	KL-0039-7622	Sleeve Set (short) BMW E36 with adaptor (for KL-0043-85.. with hydr. spindle)
HS6*	KL-0039-7621	Sleeve Set (short) BMW E36 with adaptor (for KL-0043-85..)

HS1**	KL-0039-7633	Sleeve Set (long) BMW E30
HS2**		
HS3**		
HS4**		

## KL-0039-... Series

P1	KL-0039-710	PressTool Set (short) Renault Master, Vauxhall / Opel Movano, with hydraulic cylinder.
	KL-0039-7100	PressTool Set (short) Renault Master, Vauxhall / Opel Movano, without hydraulic cylinder
HS2*	KL-0039-712	Sleeve Set (short) Renault Master, Vauxhall / Opel Movano
HS4*		
HS2*	KL-0039-722	Sleeve Set (short) Renault Master, Vauxhall / Opel Movano upper ball joint
HS4*		
HS2*	KL-0039-732	Sleeve Set (short) Renault Master, Vauxhall / Opel Movano lower ball joint
HS4*		
P1	KL-0039-730	Press Tool Set with hydr. cylinder Renault Master, Vauxhall / Opel Movano
HS2*	KL-0039-732	Press / Support Sleeve Set Renault Master/Opel Movano, lower suspension ball joint
HS4*		

## KL-0039-... Series

P1	KL-0711-11 L	Press Tool Set with hydraulic cylinder Volvo S40 / V40 lower suspension ball joint
	KL-0711-110 L	Press Tool Set without hydraulic cylinder Volvo S40 / V40 Tragel.ohne Hydr. Zyl. lower suspension ball joint
HS2*	KL-0711-111	Press / Support Sleeve Set
HS4*		
HS6*	KL-0711-112	Upgrade Kit KL-0043-8510

## KL-0250-40

## Extractor for Clamping Bolt and Ball Joint (Pat. e.g. US-Patent 6,546,610)

2

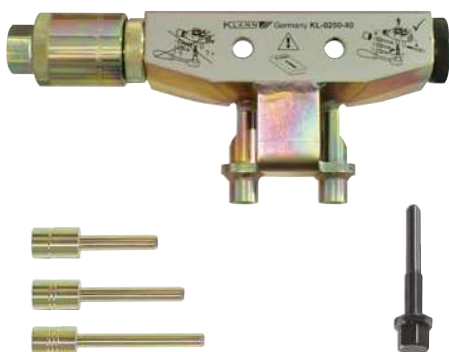

Suitable for Audi A4 (up to 2000) / VW Passat front axle (up to 2005).

**Essential tool for the extraction of the upper wishbone pivot pin clamping bolt out of the steering knuckle clamping bore.**

The removal of the long retaining bolt securing the double ball-joints is a serious problem, due to the severe corrosion leading to the bolt becoming extremely stubborn to remove.

Previously the only method has been a hammer and drift, which is not only time-consuming, but entails greater risks to the mechanic, and also risks damage to the suspension components.

**The extractor KL-0250-40 allows a quick, easy and risk-free extraction of the long retaining bolt and both ball-joints. The tool functions for both left and right-hand sides of the suspension.**

**Application example:**

- Mount tool with pressure unit on steering knuckle (with pressure drift I inserted).
- Drive hex nut by means of an impact wrench and push back the hex clamping bolt. The loosening process takes place with a loud noise.
- Extract the hex clamping bolt with the pressure unit in 3 stages. For this, insert the pressure drifts II + III one after another.
- Pull out the hex clamping bolt completely. In case it is not yet possible to pull out the hex clamping bolt completely, use the supplementary pressure drift set **KL-0250-402**, for the entire extraction of the clamping bolt.
- Remove the hex nut. Completely remove the pressure drift so that the clamping bore is clear.
- Push both pivot pins out of the clamping bore by means of the pressure spindle.

**Advantages:**

- Large cost savings.
- Substantial savings of between 2 and 3 hours.
- No risk of damage to the suspension components.

**Technical Data:**

Weight:	2.4 kg
---------	--------

**Scope of Delivery:****KL-0250-40 Extractor for Clamping Bolt and Ball Joint**

Part No.	Description	Qty.
KL-0250-4001	Tool body	1
KL-0250-4002	Thread adaptor (with big bore)	1
KL-0250-4005	Pressure screw M10 x 1.25 x 95 mm	1
KL-0250-4011	Housing	1
KL-0250-4012	Pressure drift I (Length 78 mm)	1
KL-0250-4013	Nut	1
KL-0250-4014	Pressure drift II (Length 98 mm)	1
KL-0250-4015	Pressure drift III (Length 118 mm)	1
KL-0014-0030	Molybdenum disulphide paste 50g (not III.)	1

## KL-0250-402

## Supplementary Pressure Drift Set



Used to press out the hex clamping bolt completely out of the clamping bore.

**Scope of Delivery:****KL-0250-402 Supplementary Pressure Drift Set**

Part No.	Description	Qty.
KL-0250-4016	Pressure drift IV (Length 138 mm)	1
KL-0250-4017	Pressure drift V (Length 158 mm)	1
KL-0250-4018	Pressure drift VI (Length 178 mm)	1

## KL-0250-403

## Pressure Drift Puller



The pressure drift puller **KL-0250-403** enables the pressure drifts to be pulled out of the tool body.



Extractor with extraction device for clamping bolt

(German Utility Model)

KL-0250-41 KA

Suitable for Audi A4 (8E) and A6 (2004 onwards).  
Essential tool for the extraction of the upper wishbone pivot pin clamping bolt out of the steering knuckle clamping bore.

Essential tool for the extraction of the upper wishbone pivot pin clamping bolt out of the steering knuckle clamping bore.

Removing the upper clamping bolt from the steering knuckle has always been a serious problem for the mechanic when the components are heavily corroded.

Not only is the usual technique using hammer, welding torch, angle grinder and drift time-consuming and arduous, but there is also the risk of damaging steering knuckles, pivot pins and wishbone struts.

The extractor **KL-0250-41 KA** with its proper pressure unit and extraction device, enables the quick and professional extraction of the hex clamping bolt. The loosened clamping bolt can be removed using the extraction device.

The tool is suitable for both right and left suspensions.

Application example:

- Mount the extractor with the pressure unit and the fixing unit on the steering knuckle.
- Screw in the hex nut of the pressure unit using the special socket 24 mm hex and a 1/2"-impact wrench. The hex clamping bolt is pressed out. The loosening process takes place with a loud noise.
- Remove the extractor. Install the extraction device to extract the loosened clamping bolt.
- Screw in the hex nut of the extraction device using the special socket 24 mm hex and remove the hex clamping bolt completely.

Advantages

- Large cost savings.
- Substantial time savings of between 2 and 3 hours .
- No risk of damage to the suspension components.

Technical Data:

Weight:	8.2 kg
---------	--------

Scope of Delivery:

KL-0250-41 KA    Extractor with extraction device for clamping bolt

Part No.	Description	Quantity
KL-0250-410	Extractor for clamping bolt	1
KL-0250-416	Extraction device for clamping bolt size 16 mm	1
KL-0250-417	Upgrade Kit Audi A6	1
KL-0014-0030	Molybdenum disulphide paste 50g	1
KL-0250-4190	Plastic storage case	1



2

Pivot Pin Removal Tool

KL-0250-42

Suitable for Audi A4 (2001 onwards) and Audi A6 (2004 onwards).

This tool is designed to punch a pivot pin out of the wishbone strut.



2

Patented

✓ High-quality product made in Germany.

✓ Forks are removable by a 90° rotation and feature a T-bolt locking mechanism.

✓ All components are available as spare parts.

Interchangeable forks enable quick and easy adjustment to the required ball joint head size.

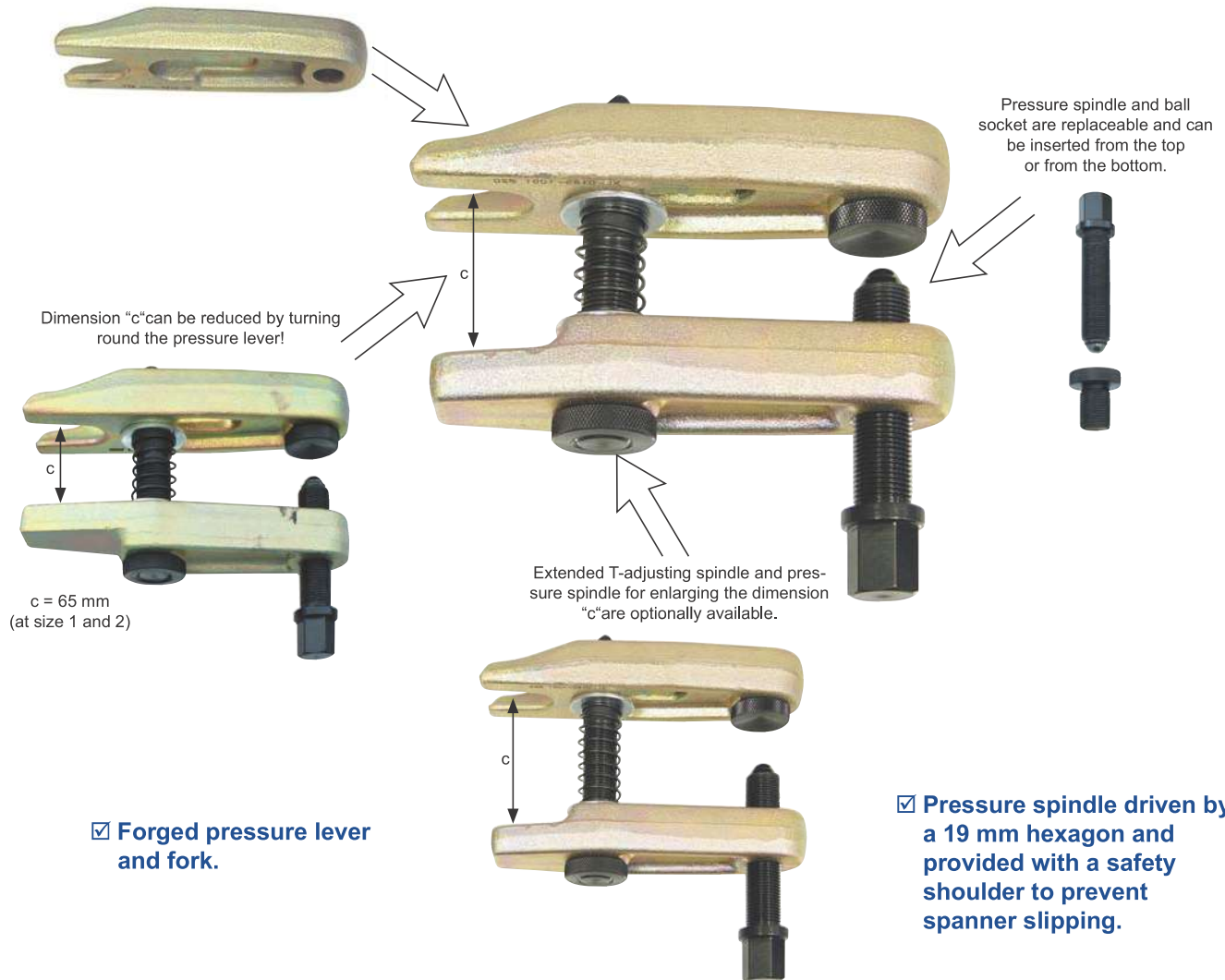

✓ Forged pressure lever and fork.

✓ Pressure spindle driven by a 19 mm hexagon and provided with a safety shoulder to prevent spanner slipping.

✓ Infinitely adjustable to the required pivot pin height.

✓ A wide range of forks for the most different kinds of ball joint connections is available.

## Ball Joint Extractors

(Pat. e.g. US-Patent 5,906,034)

KL-0165-Series



**KL-0165-12**  
Mercedes W140 (S-class)  
Front axle etc.

**KL-0165-14**  
Audi A4 / VW Passat  
Guide joint



**KL-0165-14**  
VW T4  
Track rod joint



**KL-0165-20**  
Mercedes W202 (C-class)  
Track rod joint etc.



**KL-0165-22**  
VW-Touareg  
Track rod joint etc.



**KL-0165-25**  
Mercedes W230 (SL)  
lower suspension ball joint



**KL-0165-23**  
VW-Touareg  
Suspension ball joint etc.



**KL-0165-23**  
Mercedes G-Model  
Steering box reversing lever etc.

2



## KL-0165-0 K

## Ball Joint Extractor Set size 1

(Pat. e.g. US-Patent 5,906,034)

2

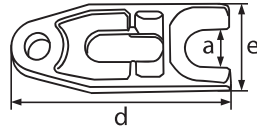

Suitable for cars and small trucks e.g.

- with fork KL-0165-1201 for: Mercedes S-Class (W220) and W140 suspension ball joint / guide joint front axle; VW Golf (IV) track rod ball joint etc.
- with fork KL-0165 1401 for: Audi A4; VW Passat; Škoda Superb guide joint; VW T4 track rod ball joint etc.

Essential tool set for VW-Audi, Seat, Škoda, Mercedes, Opel/Vauxhall etc.

### Technical Data:

Weight:	6.5 kg
---------	--------

### Scope of Delivery:

#### KL-0165-0 K Ball Joint Extractor Set size 1

Part No.	Description	Qty.
KL-0165-100	Base tool without fork (Spindle M18x1.5)	1
KL-0165-1001	Fork - a=20 mm - e=50 mm - d=165 mm	1
KL-0165-1101	Fork - a=22 mm - e=50 mm - d=165 mm	1
KL-0165-1201	Fork - a=24 mm - e=50 mm - d=165 mm	1
KL-0165-1301	Fork - a=27 mm - e=50 mm - d=165 mm	1
KL-0165-1401	Fork - a=30 mm - e=50 mm - d=165 mm	1
KL-0165-1090	Plastic storage case	1

## KL-0165-1

## Ball Joint Extractor Set

(Pat. e.g. US-Patent 5,906,034)

For passenger cars and vans. (size 1 and size 2).

### Technical Data:

Weight:	10,5 kg
---------	---------

### Scope of Delivery:

#### KL-0165-1 Ball Joint Extractor Set

Part No.	Description	Qty.
KL-0165-100	Base tool without fork (Spindle M18x1.5)	1
KL-0165-1001	Fork - a=20 mm - e=50 mm - d=165 mm	1
KL-0165-1101	Fork - a=22 mm - e=50 mm - d=165 mm	1
KL-0165-1201	Fork - a=24 mm - e=50 mm - d=165 mm	1
KL-0165-1301	Fork - a=27 mm - e=50 mm - d=165 mm	1
KL-0165-1401	Fork - a=30 mm - e=50 mm - d=165 mm	1
KL-0165-2001	Fork - a=22 mm - e=60 mm - d=165 mm	1
KL-0165-2101	Fork - a=24 mm - e=60 mm - d=165 mm	1
KL-0165-2201	Fork - a=26 mm - e=60 mm - d=165 mm	1
KL-0165-2301	Fork - a=30 mm - e=60 mm - d=165 mm	1
KL-0165-1090	Plastic storage case	1

## KL-0165-100

## Base Tool without Fork

The base tool **KL-0165-100** used with a fork (size 1), for example **KL-0165-1201**, is designed for the separation of ball joint connections in suspension and steering systems.

### Scope of Delivery

#### KL-0165-100 Base tool without fork

Part No.	Description	Qty.
KL-0165-1002	Pressure lever	1
KL-0165-1003	T- adjusting spindle M18x1.5 x 110	1
KL-0165-1004	Pressure spindle M18x1.5 x 70	1
KL-0165-1005	Ball socket	1
KL-0165-1006	Knurled nut M18x1.5	1
KL-0165-1007	Spring	1
KL-0165-1008	Plain washer Ø18 mm	1





## Ball Joint Extractor size 1

(Pat. e.g. US-Patent 5,906,034)

KL-0165-10

Universally suitable.

Ideal for Audi A6 Avant (4A), Golf (IV) track rod joint and Peugeot 307 (2.0L, HDI, 136 PS, model 2006) suspension ball joint at the bottom (Fork opening a=20 mm)

The ball joint extractor **KL-0165-10** is the ideal tool for separating ball joint connections in suspension and steering systems.

Scope of Delivery:

**KL-0165-10 Ball Joint Extractor size 1**

Part No.	Description
KL-0165-100	Base tool without fork (Spindle M18×1.5)
KL-0165-1001	Fork - a=20 mm - e=50 mm - d=165 mm

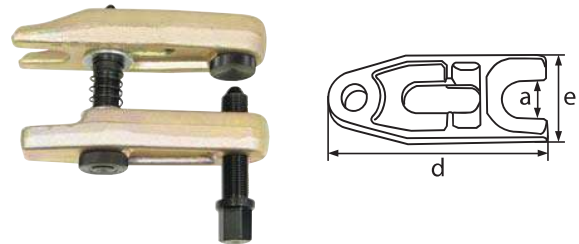

2

## Ball Joint Extractor size 1

KL-0165-11

Scope of Delivery:

**KL-0165-11 Ball Joint Extractor size 1**

Part No.	Description
KL-0165-100	Base tool without fork (Spindle M18×1.5)
KL-0165-1101	Fork - a=22 mm - e=50 mm - d=165 mm



## Ball Joint Extractor size 1

(Pat. e.g. US-Patent 5,906,034)

KL-0165-12

Universally suitable.

Ideal for Mercedes S-Class (W220), W140, suspension ball joint / guide joint front axle, VW Golf (IV) track rod joint etc. (Fork opening a=24 mm)

The ball joint extractor **KL-0165-12** is the ideal tool for separating ball joint connections in suspension and steering systems.

Scope of Delivery:

**KL-0165-12 Ball Joint Extractor size 1**

Part No.	Description
KL-0165-100	Base tool without fork (Spindle M18×1.5)
KL-0165-1201	Fork - a=24 mm - e=50 mm - d=165 mm

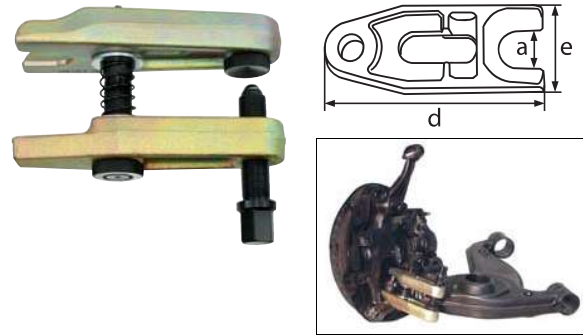

## Ball Joint Extractor size 1

(Pat. e.g. US-Patent 5,906,034)

KL-0165-13

Universally suitable.

Ideal for VW LT, Mercedes Sprinter (906) track rod etc. (Fork opening a=27 mm)

The ball joint extractor **KL-0165-13** is the ideal tool for separating ball joint connections in suspension and steering systems.

Scope of Delivery:

**KL-0165-13 Ball Joint Extractor size 1**

Part No.	Description
KL-0165-100	Base tool without fork (Spindle M18×1.5)
KL-0165-1301	Fork - a=27 mm - e=50 mm - d=165 mm

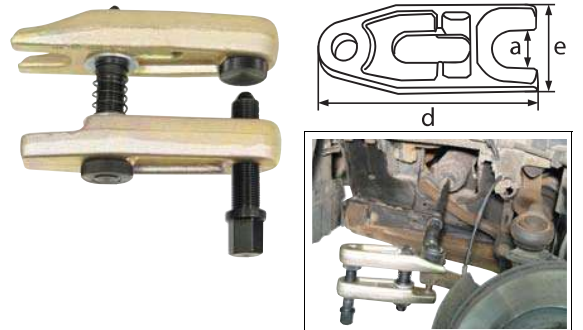

## Ball Joint Extractor size 1

(Pat. e.g. US-Patent 5,906,034)

KL-0165-14

Universally suitable.

Ideal for Audi A4; VW Passat; Skoda Superb, guide joint, VW T4 track rod joint etc. (Fork opening a=30 mm)

The ball joint extractor **KL-0165-14** is the ideal tool for separating ball joint connections in suspension and steering systems.

Scope of Delivery:

**KL-0165-14 Ball Joint Extractor size 1**

Part No.	Description
KL-0165-100	Base tool without fork (Spindle M18×1.5)
KL-0165-1401	Fork - a=30 mm - e=50 mm - d=165 mm

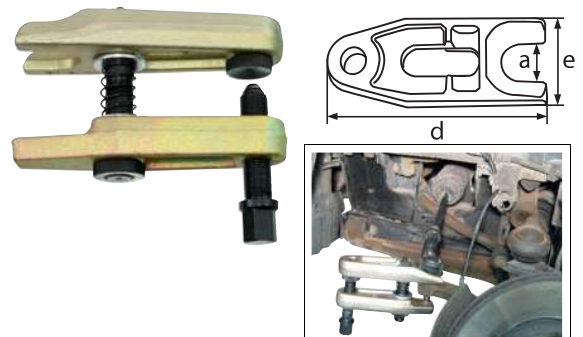



**KL-0165-20**

**Ball Joint Extractor size 2**

(Pat. e.g. US-Patent 5,906,034)



**Universally suitable.**

**Ideal for Mercedes M-Class (W163), E-Class (W211), W220 (S-Class), upper guide joint SLK (W170), C-Class (W202), S-Class (W220), track rod etc. (Fork opening a=22 mm)**

The ball joint extractor **KL-0165-20** is the ideal tool for separating ball joint connections in suspension and steering systems.

**Scope of Delivery:**

**KL-0165-20 Ball Joint Extractor size 2**

Part No.	Description
KL-0165-100	Base tool without fork (Spindle M18×1.5)
KL-0165-2001	Fork - a=22 mm - e=60 mm - d=165 mm

**KL-0165-21**

**Ball Joint Extractor size 2**

(Pat. e.g. US-Patent 5,906,034)

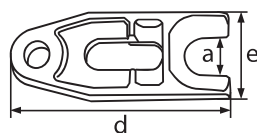

**Universally suitable.**

**(Fork opening a=24 mm)**

The ball joint extractor **KL-0165-21** is the ideal tool for separating ball joint connections in suspension and steering systems.

**Scope of Delivery:**

**KL-0165-21 Ball Joint Extractor size 2**

Part No.	Description
KL-0165-100	Base tool without fork (Spindle M18×1.5)
KL-0165-2101	Fork - a=24 mm - e=60 mm - d=165 mm

**KL-0165-22**

**Ball Joint Extractor size 2**

(Pat. e.g. US-Patent 5,906,034)



**Universally suitable.**

**Ideal for VW Touareg; Porsche Cayenne track rod and upper guide joint, Mercedes E-Class (W210), Sprinter track rod joint, Ford Transit track rod joint, VW Golf (IV) lower suspension ball joint etc. (Fork opening a=26 mm)**

The ball joint extractor **KL-0165-22** is the ideal tool for separating ball joint connections in suspension and steering systems.

**Scope of Delivery:**

**KL-0165-22 Ball Joint Extractor size 2**

Part No.	Description
KL-0165-100	Base tool without fork (Spindle M18×1.5)
KL-0165-2201	Fork - a=26 mm - e=60 mm - d=165 mm

**KL-0165-23**

**Ball Joint Extractor size 2**

(Pat. e.g. US-Patent 5,906,034)



**Universally suitable.**

**Ideal for VW Touareg; Porsche Cayenne suspension ball joint, VW T4 lower suspension ball joint, Mercedes G-Model track rod joint and steering box reversing lever, Ford Transit lower suspension ball joint (Fork opening a=30 mm)**

The ball joint extractor **KL-0165-23** is the ideal tool for separating ball joint connections in suspension and steering systems.

**Scope of Delivery:**

**KL-0165-23 Ball Joint Extractor size 2**

Part No.	Description
KL-0165-100	Base tool without fork (Spindle M18×1.5)
KL-0165-2301	Fork - a=30 mm - e=60 mm - d=165 mm

## Ball Joint Extractor size 2

(Pat. e.g. US-Patent 5,906,034)

KL-0165-24

Universally suitable.

(Fork opening a=34 mm)

The ball joint extractor **KL-0165-24** is the ideal tool for separating ball joint connections in suspension and steering systems.

Scope of Delivery:

**KL-0165-24 Ball Joint Extractor size 2**

Part No.	Description
KL-0165-100	Base tool without fork (Spindle M18x1.5)
KL-0165-2401	Fork - a=34 mm - e=60 mm - d=165 mm

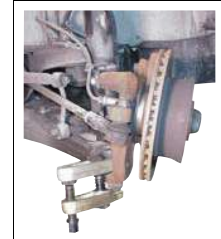
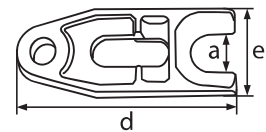

2

## Ball Joint Extractor size 2

(Pat. e.g. US-Patent 5,906,034)

KL-0165-25

Universally suitable.

Ideal for Mercedes E-Class (W211), CLS (W219), S-Class (W220) and SL (W230) lower suspension ball joint etc.

(Fork opening a=24 mm)

The ball joint extractor **KL-0165-25** is the ideal tool for separating ball joint connections in suspension and steering systems.

Scope of Delivery:

**KL-0165-25 Ball Joint Extractor size 2**

Part No.	Description
KL-0165-100	Base tool without fork (Spindle M18x1.5)
KL-0165-2501	Fork - a=24mm - e=60mm - d=165mm

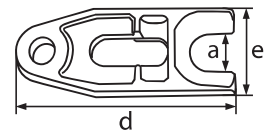

## Ball Joint Extractor Set

(Pat. e.g. US-Patent 5,906,034)

KL-0165-3

Suitable for Mercedes HGV etc.

Indispensable for the quick and easy separation of ball joint connections in suspension and steering systems.

The ever-increasing number of different ball-joints used in suspension and steering systems in today's vehicles has lead to the need for an ever-widening range of ball-joint extractors for separating ball joint connections from steering knuckles and steering arms, due to the wide range of diameters and lengths of the ball-joints.

Conical ball-joint pins require an increased stability and strength of the ball-joint extractors to achieve easy separation. When separating ball joint connections, it is very important that the separation pressure point and the angle can be adjusted on the extractor.

The ball joint extractor set **KL-0165-3** offers the mechanic a tool with high stability and universal application possibilities. Interchanging the forks enables the extractor to be adjusted to the required ball joint diameter and pivot pin height.

Scope of Delivery:

**KL-0165-3 Ball Joint Extractor Set**

Part No.	Description
KL-0165-300	Base tool without fork (Spindle M24x1.5)
KL-0165-3001	Fork a=30 mm, e=80 mm, d=200 mm - e.g. suitable for Landini-Tractors
KL-0165-3101	Fork a=34 mm, e=80 mm, d=200 mm
KL-0165-3201	Fork a=40 mm, e=80 mm, d=200 mm - e.g. suitable for Mercedes, MAN, Scania, Volvo, etc.
KL-0165-3301	Fork a=42 mm, e=80 mm, d=200 mm - e.g. suitable for Mercedes, MAN, Scania, Volvo, etc. and John Deere-Tractors
KL-0165-3401	Fork a=47 mm, e=80 mm, d=200 mm

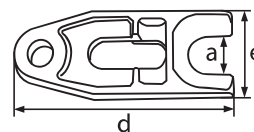

## KL-0165-35 Ball Joint Extractor size 3

(Pat. e.g. US-Patent 5,906,034)

Suitable for suspension ball joint MB Sprinter (1995 onwards), VW LT (1998 onwards), guide joint VW T4 etc.  
(Fork opening  $a=47$  mm)

The ball joint extractor **KL-0165-35** is the ideal tool for separating ball joint connections in suspension and steering systems.

### Scope of Delivery:

#### KL-0165-35 Ball Joint Extractor size 3

Part No.	Description
KL-0165-300	Base tool without fork (Spindle M24×1.5)
KL-0165-3501	Fork - $a=30$ mm - $e=80$ mm - $d=200$ mm

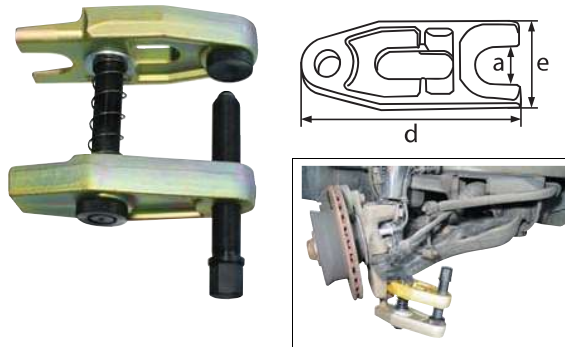

## KL-0163-21 Ball Joint Extractor size 2

(German Utility Model)

Suitable for VW-Audi, BMW, Fiat, Ford, Mercedes, Nissan, Opel, Peugeot, Renault, Rover, Saab, Toyota, Volvo.

The ball joint extractor **KL-0163-21** is the ideal tool for separating ball joint connections in suspension and steering systems.

### Technical Data

a:	20 mm
c:	2-stage up to 50 mm

### Scope of Delivery:

#### KL-0163-21 Ball Joint Extractor size 2

Part No.	Description	Qty.
KL-0163-2101	Fork Body	1
KL-0163-2102	Pressing Lever	1
KL-0163-2103	Pressing Spindle	1
KL-0163-2104	Bolt	1
KL-0163-2105	Thread Bush	1

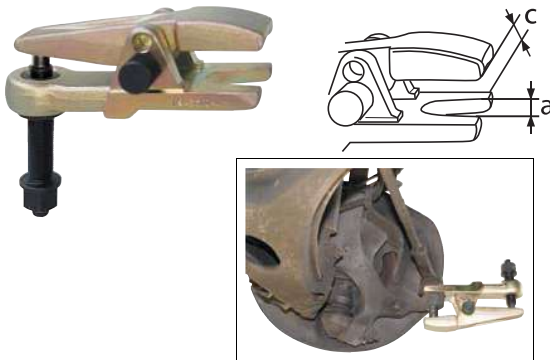

## KL-0163-221 Adaptor with rolled pins

### Scope of Delivery:

#### KL-0163-221 Adaptor with rolled pins

Part No.	Description	Qty.
KL-0163-2202	Adaptor	1
KL-0163-2204	Roller pin	2



## KL-0163-22 Ball Joint Extractor size 2

(German Utility Model)

Suitable for Opel, VW Transporter, etc.

The ball joint extractor **KL-0163-22** is the ideal tool for separating ball joint connections in suspension and steering systems.

### Technical Data:

a:	20 mm
c:	2-stage up to 95 mm

### Scope Delivery:

#### KL-0163-22 Ball Joint Extractor size 2

Part No.	Description	Qty.
KL-0163-2201	Fork Body	1
KL-0163-2202	Pressing Lever	1
KL-0163-2203	Pressing Spindle	1
KL-0163-2204	Roller pin $\varnothing 10 \times 40$	2
KL-0163-2104	Bolt	1
KL-0163-2105	Thread Bush	1

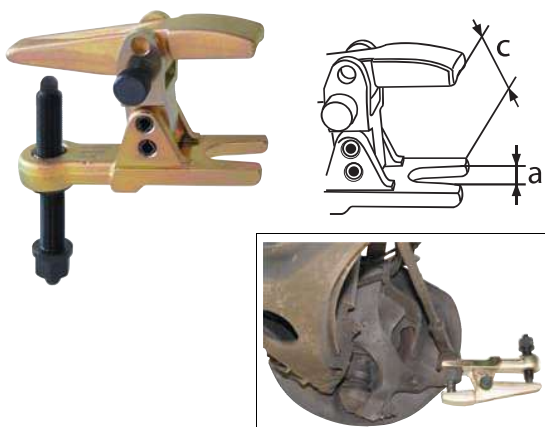



## Ball Joint Extractor

(universal)

KL-0163-1

Suitable for VW-Audi, BMW, Fiat, Ford, Mercedes, Nissan, Opel/Vauxhall, Peugeot, Renault, Rover, Saab, Toyota, Volvo.

Designed to extract the ball joint pivot pin out of the steering arm, steering knuckle, stabilizer etc.

### Technical Data:

a:	20 mm
c:	2-stage up to 50 mm

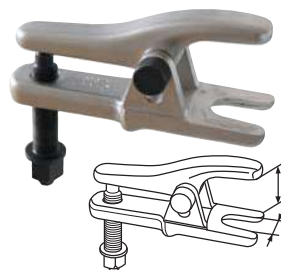

2

## Ball Joint Extractor

(universal)

KL-0163-2

Suitable for Opel/Vauxhall, VW Transporter etc.

Designed to extract the ball joint pivot pin out of the steering arm, steering knuckle, stabilizer etc.

### Technical Data:

a:	20 mm
c:	2-stage, 50-80 mm

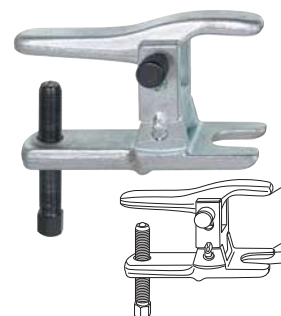

## Ball Joint Extractor

(universal)

KL-0162-1

Designed to extract the track rod pivot pin out of the steering arm, steering knuckle, stabilizer etc.

### Advantage:

Dimension c is infinitely adjustable, thus providing a wider range of applications.

### Technical Data:

a:	23 mm
c:	30 - 50 mm



## Ball Joint Extractor

KL-0162-2

Designed to extract the track rod pivot pin out of the steering arm, steering knuckle, stabilizer etc.

### Advantage:

Dimension c is infinitely adjustable, thus providing a wider range of applications.

### Technical Data:

a:	30 mm
c:	30 - 85 mm

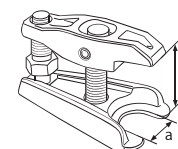

## Ball Joint Extractor size 1

(Pat. e.g. US-Patent 5,906,034)

KL-0165-15

Universally suitable.

Ideal tool for suspension ball joints on Fiat Punto.  
(Fork opening a=22 mm)

The ball joint extractor **KL-0165-15** is the ideal tool for separating ball joint connections in suspension and steering systems.

### Scope of Delivery:

#### KL-0165-15 Ball Joint Extractor size 1

Part No.	Description
KL-0165-1502	Pressure lever
KL-0165-1003	T-adjusting spindle (M18x1.5 x 110)
KL-0165-1004	Pressure spindle (M18x1.5 x 70)
KL-0165-1005	Ball socket
KL-0165-1006	Knurled nut (M18x1.5)
KL-0165-1007	Spring
KL-0165-1008	Plain washer Ø 18 mm
KL-0165-1501	Fork 22mm

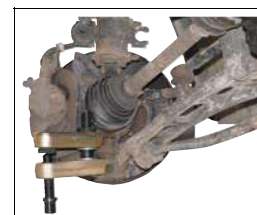

## KL-0161-.. Ball Joint Extractor

2

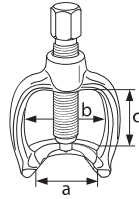

Designed to extract the track rod pivot pin out of the steering arm, steering knuckle, stabilizer etc.

### KL-0161-1 Ball Joint Extractor

#### Technical Data:

a:	18 mm
b:	40 mm
c:	35 mm

### KL-0161-2 Ball-Joint Extractor

#### Technical Data:

a:	23 mm
b:	50 mm
c:	45 mm

### KL-0161-3 Ball-Joint Extractor

#### Technical Data:

a:	29 mm
b:	60 mm
c:	55 mm

### KL-0161-4 Ball-Joint Extractor

#### Technical Data:

a:	40 mm
b:	80 mm
c:	80 mm

### KL-0161-5 Ball-Joint Extractor

#### Technical Data:

a:	46 mm
b:	90 mm
c:	100 mm

## KL-0164-2 Ball Joint Extractor

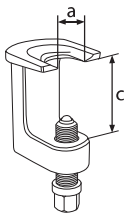

Ideal for use in narrow space conditions like on Audi, VW, BMW, Ford, Mercedes A-Class (W168), C-Class (W202), E-Class (W2109), M-Class (W163), SLK (R170), Vauxhall/Opel etc.

Designed to extract the ball joint pivot pin out of the steering arm, steering knuckle, stabilizer etc. Required for extracting the suspension ball joint pivot pin out of the steering knuckle.

#### Technical Data:

a :	23 mm
c :	55 mm
Weight:	900 g

#### Note:

Only suitable for closed ball joint pivot pins or with centre hole.

## KL-0164-3 Ball Joint Extractor

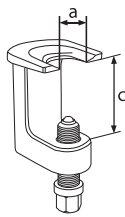

Suitable for front axle on Audi A4, A6 and A8 as well as VW Passat, Mercedes W203 etc.

Designed to extract the suspension ball joint pivot pin out of the steering knuckle.

#### Technical Data:

a :	28 mm
c.:	55 mm
Weight:	900 g

#### Note:

Only suitable for closed ball joint pivot pins or with centre hole.

## Ball Joint Extractor

KL-0164-7

Suitable for front axle on BMW 5-Series (E39), Mercedes E-Class (W211), CLS (W219), S-Class (W220) and SL (W230) lower guide joint etc.

Designed to extract the guide joint pivot pin out of the steering knuckle.

### Technical Data:

a :	24 mm
c :	55 mm
Weight:	900 g

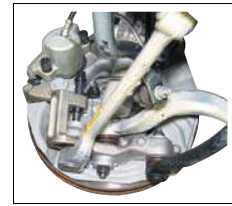
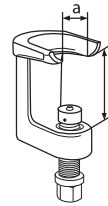

2

## Ball Joint Extractor

KL-0164-8

Suitable for front axle on Mercedes, for example: suspension ball joint and guide joint C-Class (W203), suspension ball joint E-Class (W210, track rod joint M-Class (W163), E-Class (W211), CLS (W219), S-Class (W220) and SL (W230) as well as on VW, for example: T5 track rod joint etc.

Designed to extract the pivot pin out of ball joint connections.

### Technical Data:

a :	26 mm
c :	56 mm
Weight:	750 g

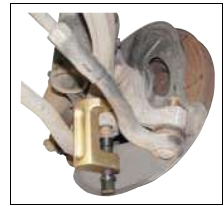

## Ball Joint Extractor

KL-0164-5

Designed to extract the pivot pin of the suspension ball joint/guide joint out of the steering knuckle, for example Mercedes W211, W220 . Can also be used for pressing the outer track rod pivot pin out of the steering arm. Ideal tool for BMW E46 and Mercedes W168 etc.

### Technical Data:

a :	24 mm
c :	45 mm
Drive:	17 mm
Ø-outside	55 mm

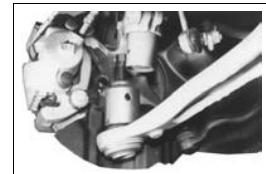
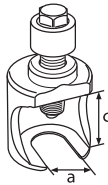

## Ball Joint Extractor

KL-0161-8

Suitable for Mercedes G-Model; S-Class (W220), Porsche Cayenne, VW Touareg, Golf IV etc.

This two-arm extractor can be used universally. Allows the user quick and trouble-free extraction of ball joint pivot pins, for example, out of steering arms, steering knuckles, stabilizers etc.

### Technical Data:

a:	18 - 45 mm
c:	60 mm

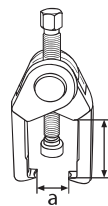

## Suspension Ball Joint Extractor

KL-0161-9

Suitable for Fiat Ducato etc.

Designed to extract the suspension ball joint pivot pin out of the steering knuckle. Specially designed for the front axle.

### Technical Data:

a:	34 mm
c:	51 mm

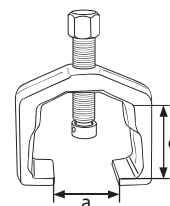

## KL-0049-360 Jointed Latch Hook

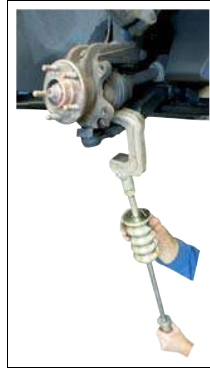

Especially suitable for removing the wishbone from the suspension ball joint clamping hole in conjunction with the slide hammer **KL-0049-31 / KL-0049-300**. Due to its profiled shape, the hook can be positioned very close to the suspension ball joint.

### Scope of Delivery: KL-0049-360 Jointed Latch Hook

Part No.	Description	Qty.
KL-0049-3600	Latch Hook without Joint	1
KL-0049-3502	Joint M18	1

2

## KL-0049-300 Slide Hammer 4.8 kg, base tool

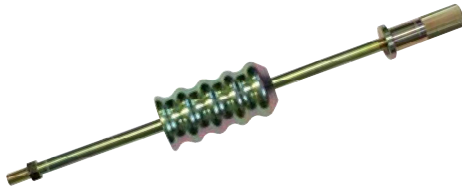

The ideal tool for extracting stuck or tight-fitting components such as half-shafts, universally jointed drive shafts, injector nozzles etc. To be used with the appropriate adaptors and puller bolts.

### Scope of Delivery: KL-0049-300 - Slide hammer 4.8 kg, base tool

Part No.	Description	Qty.
KL-0049-3001	Tie rod for KL-0049-3	1
KL-0049-3002	Hammer weight 4.8 kg for KL-0049-3	1
KL-0049-3003	Handle for KL-0049-3	1
KL-0049-3004	Hex nut M18	1

## KL-0160-... Separator Fork 18 mm



The wedge profiled fork allows easy and quick separation of conical seat ball-joints.

Also useful for removal of shock-absorbers and steering-column clamps.



### Warning:

Separator Forks may damage the gaiter.

### KL-0160-1 Separator Fork 18 mm

#### Technical Data:

Fork opening	18 mm
--------------	-------

### KL-0160-2 Separator Fork 23 mm

#### Technical Data:

Fork opening	23 mm
--------------	-------

### KL-0160-3 Separator Fork 30 mm

#### Technical Data:

Fork opening	30 mm
--------------	-------

### KL-0160-4 Separator Fork 40 mm

#### Technical Data:

Fork opening	40 mm
--------------	-------



## Separator Fork Set

KL-0160-7 K

5-piece Separator Fork Set.

Consists of:

3 Fork heads with openings  $a = 17.5 \text{ mm}$ ,  $a = 23.5 \text{ mm}$  and  $a = 28.5 \text{ mm}$ .

A 200 mm Handle and an Adaptor with 10 mm Ø Shaft and 175 mm Length, suitable for pneumatic hammer.

The wedge form of the forks enable the quick and easy separating of ball joint pins from their conical seats.

**Warning:**

Separator Forks may damage the gaiter.



2

## Track Rod Head Socket

KL-0169-50

**Universal application.**

Designed for the quick and trouble-free removal and installation of the track rod head. After separating the ball joint from steering knuckle, slip tool over track rod head and remove.

**Technical Data:**

U-opening:	34,9 × 19 mm
Inner-Ø:	23,8 mm
Drive:	1/2"
Length:	57 mm
Weight:	490 g

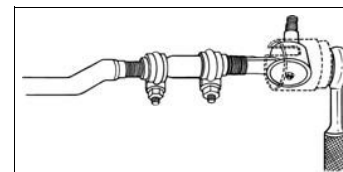

## Track Rod Adjusting Tool

KL-0169-1

For loosening and adjusting stubborn track rods on passenger cars. The broad serrated jaws prevent damage to the track rod.

Application: track rods Ø 14-23 mm



## Adaptor for Track Rods

KL-0169-1001

Suitable from track rod tubes as from Ø 11 mm upwards.



## KL-0169-318 Open Ended Spanner Socket

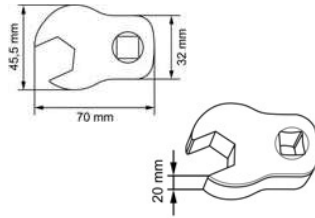
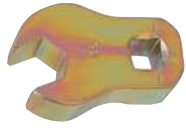

**Suitable for track rod Opel/Vauxhall Vectra B, etc.**

Extra-strong design.  
Ideal for loosening and twisting track rods.

### Technical Data:

Size (width across flats):	18 mm
Drive:	1/2"
Weight:	300 g

2

## KL-0169-321 Open Ended Spanner Socket

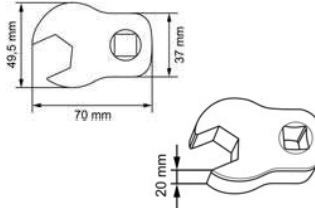

**Suitable for track rod Opel/Vauxhall Sintra, etc.**

Extra-strong design.  
Ideal for loosening and twisting track rods.

### Technical Data:

Size (width across flats):	21 mm
Drive:	1/2"
Weight:	330 g

## KL-0167-20 Track Rod Eccentric Socket Ø 33 - 42 mm



**Suitable for track rod joints with Ø 33 - 42 mm.**

This tool allows quick and easy replacement of the inner track rod joint.  
Removal of the steering gear is not necessary.

### Technical Data:

Size:	18 mm
-------	-------

## KL-0167-15 Universal Wrench for Inner Track Rod Joint Ø30-Ø43 mm



**Universally suitable for all inner track rod joints with a spherical head -Ø of from 30 mm up to 43 mm.  
Specially designed for Mercedes Sprinter (Ø43 mm).**

This tool allows quick and easy removal and installation of an inner track rod joint without having to remove the complete steering system. Suitable for spherical heads with diameters of from 30 to 43 mm.

## KL-0167-151 Set of Mounting Tools for Inner Track Rod Joints Ø30-Ø43 mm



**Suitable for Renault vehicles.**

The tool set **KL-0167-151** allows quick and easy removal and installation of an inner track rod joint without having to remove the complete steering system. Suitable for spherical heads with diameters of from 30 to 43 mm.

### Procedure:

To counter-hold the rack, the locking tools depending on the steering type have to be fixed to the rack.

The inner track rod joint is loosened and tightened by means of the universal wrench while the rack must be counter-held using the suitable locking tool.

After the inner track rod joint has been removed, the sealing ring in the steering-gear housing can be replaced quickly and easily.

### Scope of Delivery:

**KL-0167-151 Set of Mounting Tools for Inner Track Rod Joints Ø30-Ø43 mm**

Part No.	Description	Qty.
KL-0167-15	Universal wrench for inner track rod joint Ø30-Ø43mm	1
KL-0167-131	Set of counter-hold tools Renault	1

### Scope of Delivery:

**KL-0167-131 Set of Counter hold Tools Renault**

Part No.	Description	Qty.
KL-0167-1313	Counter hold tool Renault	1
KL-0167-1314	Counter hold tool Renault (KL-0167-1311 + KL-0167-1312)	1

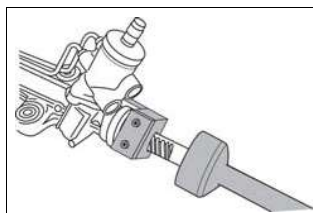

## Counter Hold Tool

KL-0167-141

Suitable for racks with a Ø of 25 mm, for example ZF power steering systems Type 7832 (974 115) on Toyota vehicles.

Designed to counter hold the rack when removing and installing an inner track rod joint. Used in conjunction with universal wrench **KL-0167-15**. Any standard ½" ratchet or ½" sliding T-Bar can be used as a holding tool.

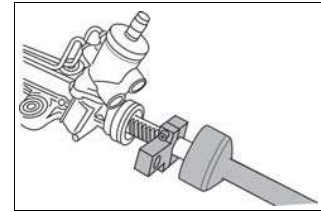

2

## Locking screw

KL-0241-1

Suitable for Audi A4, A6, VW Passat from '97 upwards etc.

### Procedure:

Move the steering rack until Pos. 1 and Pos. 2 are level. Then, screw in the locking screw **KL-0241-1**. The rack is now in the centre position so that it is possible to carry out the track basic adjustment of the right-hand and left-hand steering rod.

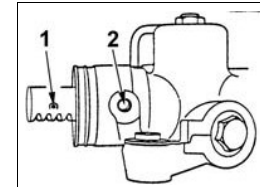

## Retention Bolt Set

KL-0322-6

Suitable for Mercedes W107, W114, W115, W116, W123, W126.

With conical tip for middle positioning of the steering while adjusting the steering geometry.



## Hose Clip Pliers

KL-0121-81

Universal Application.

Ideal for VW-Audi etc.

Works on „earless“ hose clips on cv-boots, radiator and fuel hoses.

### Technical Data:

Length:	230 mm
Weight:	340 g



## Hose Band Tool with Ratchet

KL-0121-86

Suitable for pre-manufactured and endless hose clips (e.g. Bandimax) up to 9.5 mm, for example on cv boots etc.

For the quick and easy tensioning and cutting of hose clips.

### Technical Data:

Length:	200 mm
Weight:	360 g





## KL-0240-1 Puller for Spacer Sleeves VW

2



**Suitable for vehicle models as from 1988 onwards such as VW Golf (II and III), Jetta, Vento, Polo, Passat, etc.**

When replacing steering column switches, it is necessary to firstly remove the steering wheel and then to extract the spacer sleeve from the cone. The special design of the puller **KL-0240-1** ensures that its collet chuck precisely encompasses the spacer sleeve which enables quick and smooth extraction of the spacer sleeve.

### Technical Data:

Clamping range:	27 - 30 mm
-----------------	------------

## KL-0240-2 Drive-in Mandrel for Spacer Sleeves



The drive-in mandrel **KL-0240-2** made of brass allows the spacer sleeve to be pushed into the steering column without risk of damage.

## KL-0270-3 C Wrench with 8 Bit Inserts

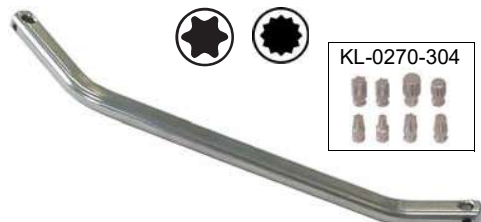

KL-0270-304



**Designed to quickly and easily loosen and tighten the bolts in door hinges.**

### Technical Data:

Size:	5/16"
Bit-Inserts:	T30, T40, T45, T50, T55, XZN-8, XZN-10, XZN-12
Length:	310 mm
Weight:	430 g
Bit-Drive:	5/16"

® = reg. trademark of Acument Intellectual Properties, LLC. USA



## KL-0270-304 Bit-Insert Set 8 pcs.



Consists of 5/16" Drive Bit-Inserts:  
(Torx®) T30, T40, T45, T50, T55,  
XZN-M8, XZN-M10, XZN-M12

® = reg. trademark of Acument Intellectual Properties, LLC. USA



## Wrench with 8 Bit Inserts

KL-0270-31 C

Suitable for Door Hinge Bolts e.g. Audi (97 - onwards); Renault Safrane / Laguna; Seat Arosa / Cordoba / Ibiza; VW Golf III / Golf IV / Passat (97 - onwards) / Polo / Vento; Škoda.

The loosening and adjusting of car doors has been so far a big issue for the mechanic as the screws are very difficult to access.

The wrench **KL-0270-31 C**, thanks to its special shape, allows the easy loosening and tightening of door hinge bolts.

Suitable for Mercedes Toe Adjustment e.g. 190 Series (W201), C-Class (W202), C-Class (W203), 200 - 300 E (W124), E-Class (W210, W211), S-Class (W220)

With 8 interchangeable 5/16" Bit inserts.

The wrench **KL-0270-31 C** is the ideal tool for setting the toe at the rear axle.

Due to its special shape, this tool allows the user to easily and accurately turn the adjusting screw that is particularly hard to access.

### Technical Data:

Bit-Inserts:	T30, T40, T45, T50, T55, XZN-8, XZN-10, XZN-12
Bit-Inserts:	20 mm
Bit-Drive:	5/16"
Length:	320 mm
Weight:	500 g

® = reg. trademark of Acument Intellectual Properties, LLC. USA

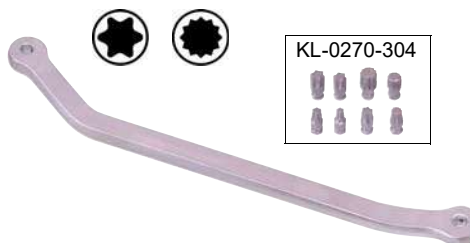

2

## Camber Gauge (in Case)

KL-0168-90 K

The **KL-0168-90 K** Camber Gauge with magnetic foot allows the existing camber angle to be memorised before the suspension is dismantled. After reassembly the camber can be set to the previous setting without time-consuming geometry check.

### Technical Data:

Weight:	500 g
---------	-------



## Camber Adjustment Tools

KL-0168-...

### Universally suitable.

With extra strong spindle (M14).

This camber adjustment tool allows a single technician working alone to adjust and set camber angles on the vehicle. This tool not only saves a lot of time, but also eliminates the need for additional labour.

The tool is placed between the strut or bodywork and the wheel-rim. The camber is adjusted by rotating the hexagonal drive.



### Camber Adjustment Tool Set (2 Pcs.)

KL-0168-1

Technical Data: (Suitable for VW Golf, Jetta, etc.)

Spin width min :	135 mm
Spin width max :	175 mm

### Camber Adjustment Tool Set (2 Pcs.)

KL-0168-2

Technical Data: (Suitable for VW Polo)

Spin width min :	155 mm
Spin width max :	180 mm

### Camber Adjustment Tool Set (2 Pcs.)

KL-0168-3

Technical Data: (Suitable for Chrysler)

Spin width min :	175 mm
Spin width max :	210 mm



## KL-0540-21 Camber Adjustment Tool



**Suitable for BMW E46 (3-series) and E53 (X5)**

The camber adjustment tool **KL-0540-21** enables the accurate and quick adjustment of the front axle camber.

The adjusting process is carried out via the exact alignment of the upper strut tower bearing.

Professional and accurate adjustment of the camber is nearly impossible without this tool.

### Technical data:

Weight:	750 g
---------	-------

## KL-0540-1 Eccentric Nut

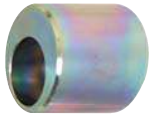

**For adjusting the toe on BMW E36, E46 rear axle.**

For this purpose, the screws on the lower wishbone have to be loosened. Then the eccentric nut is set on the wishbone fixing screw. By turning the eccentric nut, the wishbone will reach the right toe direction.

Drive:	1/2"
--------	------

## KL-0326-20 Toothed Socket



**Suitable for Mercedes M-Class (W163)**

For tightening the suspension ball joint fastening nut on the steering knuckle.

### Technical Data:

Outer diameter:	63.0 mm
Inner diameter:	52.5 mm
Tooth Width:	7.5 mm
Weight:	500 g

## KL-1340-10 Toothed Socket



**Suitable for Citroën BX (model 09/'82 until '94) / Citroën C5 / Citroën Xantia; Peugeot 305 (model 7/'82 until '90) / Peugeot 405 (as from model 6/'87) / Peugeot 406 / Peugeot 605 / Peugeot 607 etc.**

Designed to loosen and tighten screwed suspension ball joints.

### Technical Data:

Outer diameter:	52 mm
Inner diameter:	42.5 mm
Tooth Width:	5.5 mm
Weight:	520 g

## KL-1340-201 Socket Size (width across flats) 41 mm



**Suitable for Peugeot 307, Citroën C4 etc.**

Designed to loosen and tighten screwed suspension ball joints.

### Technical Data:

Size:	12-point
Drive:	1/2"
Length:	75 mm
Weight:	700 g

## KL-4031-3014 Special Socket Insert XZN M14



**Suitable for VW T4.**

Intended for the removal of the lower suspension ball joint.

### Technical Data:

Length:	55 mm
Drive:	1/2"
Weight:	110 g